



# Vertical Multistage Pumps



## KO Series

High quality and efficient vertical multi-stage centrifugal pumps with compact construction. Highly preferred with its small footprint in booster systems and connection style as overlaying (inlet at the bottom and outlet at top) occupying space at floor.

### Fields of Use

- Pressurized water supply in residential and commercial buildings
- Garden irrigation systems
- Clean water transfer

### Pump Specifications

- Pump Body : GG25 Cast Iron
- Impeller & Diffuser : Noryl
- Pump Shaft : AISI 420 Stainless Steel
- Mechanical Seal : Carbon / Ceramic / EPDM

### Technical Specifications

- Maximum Flow : 60 m<sup>3</sup>/h
- Maximum Pressure : 200 mwc
- Inlet-Outlet Diameter : 1" & 3"
- Pressure Class : PN25
- Max. Ambient Temperature : 40°C
- Fluid Temperature : 0 - 40°C
- Fluid Property : Clean, solid particle-free, chemically neutral water
- Motor Speed : 2900 rpm
- Network Connection : 3\*380V, 50Hz
- Motor Power : 0,75 - 22,5 kW
- Protection Class : IP55
- Insulation Class : F

## Identification Code

**KO 10 / 7 / 30**

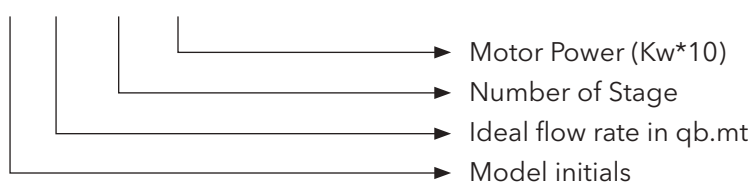

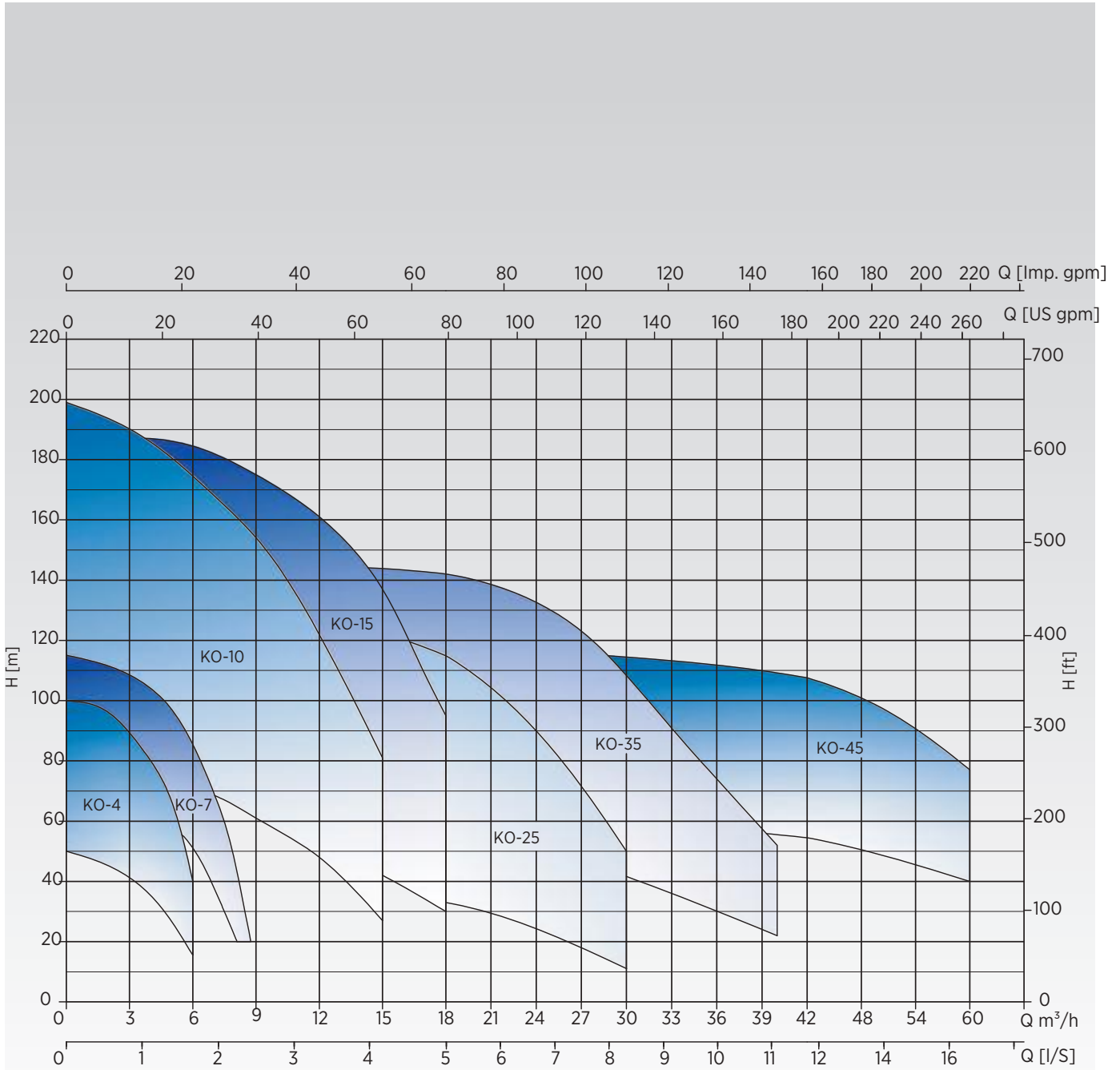

# KO Series Performance Curves

## KO 4 Series

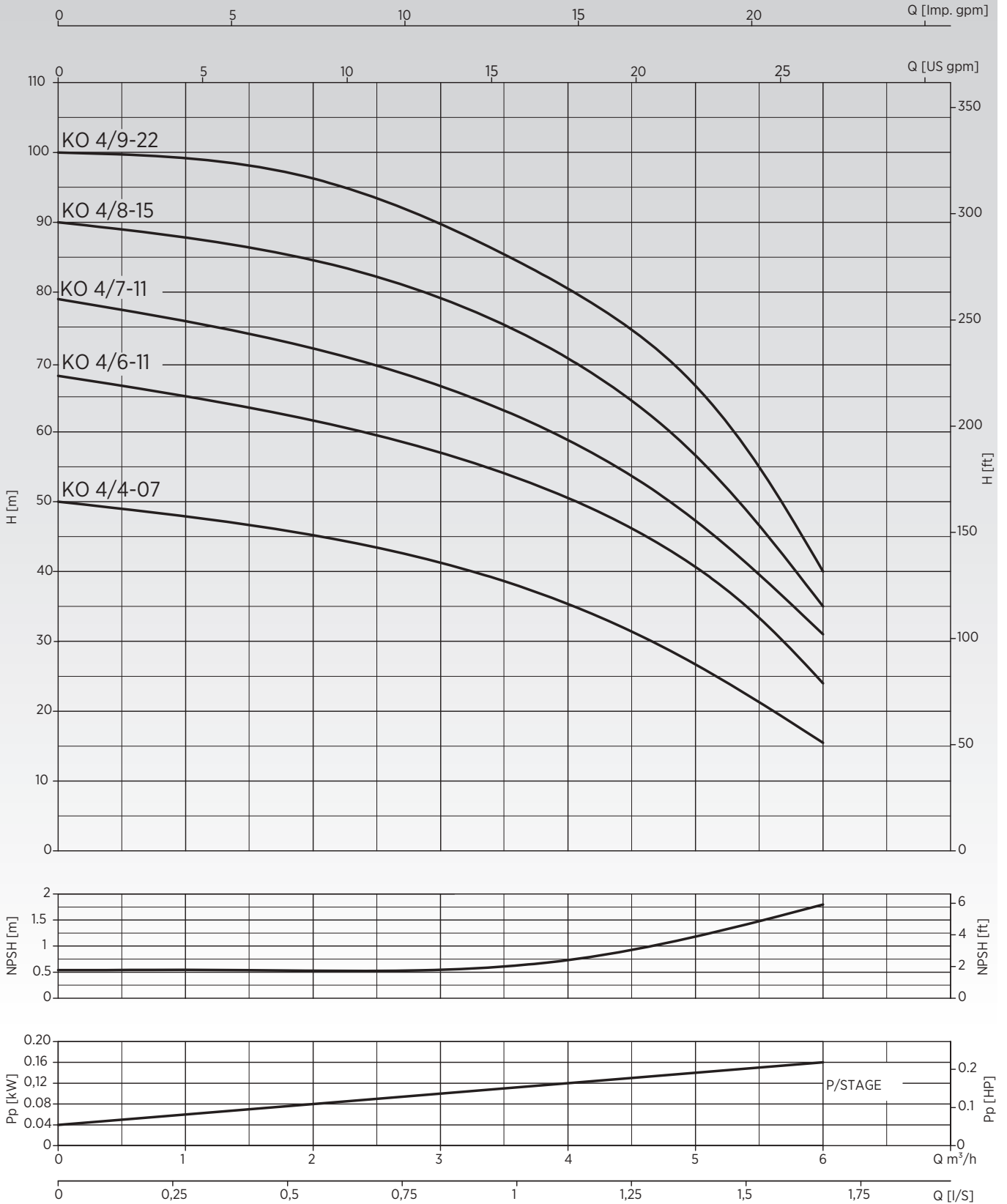



**KO 7 Series**

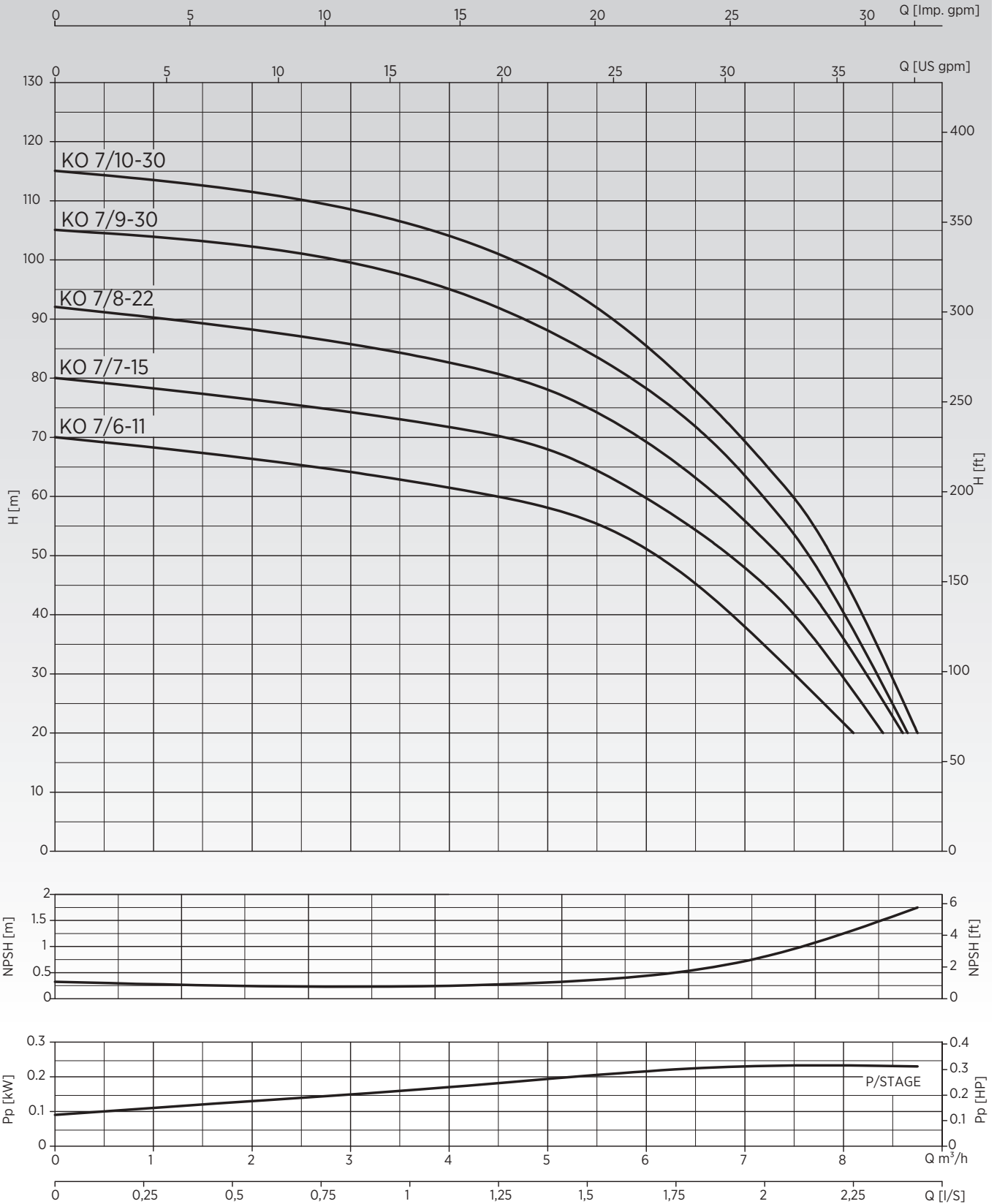

# KO Series Performance Curves

## KO 10 Series

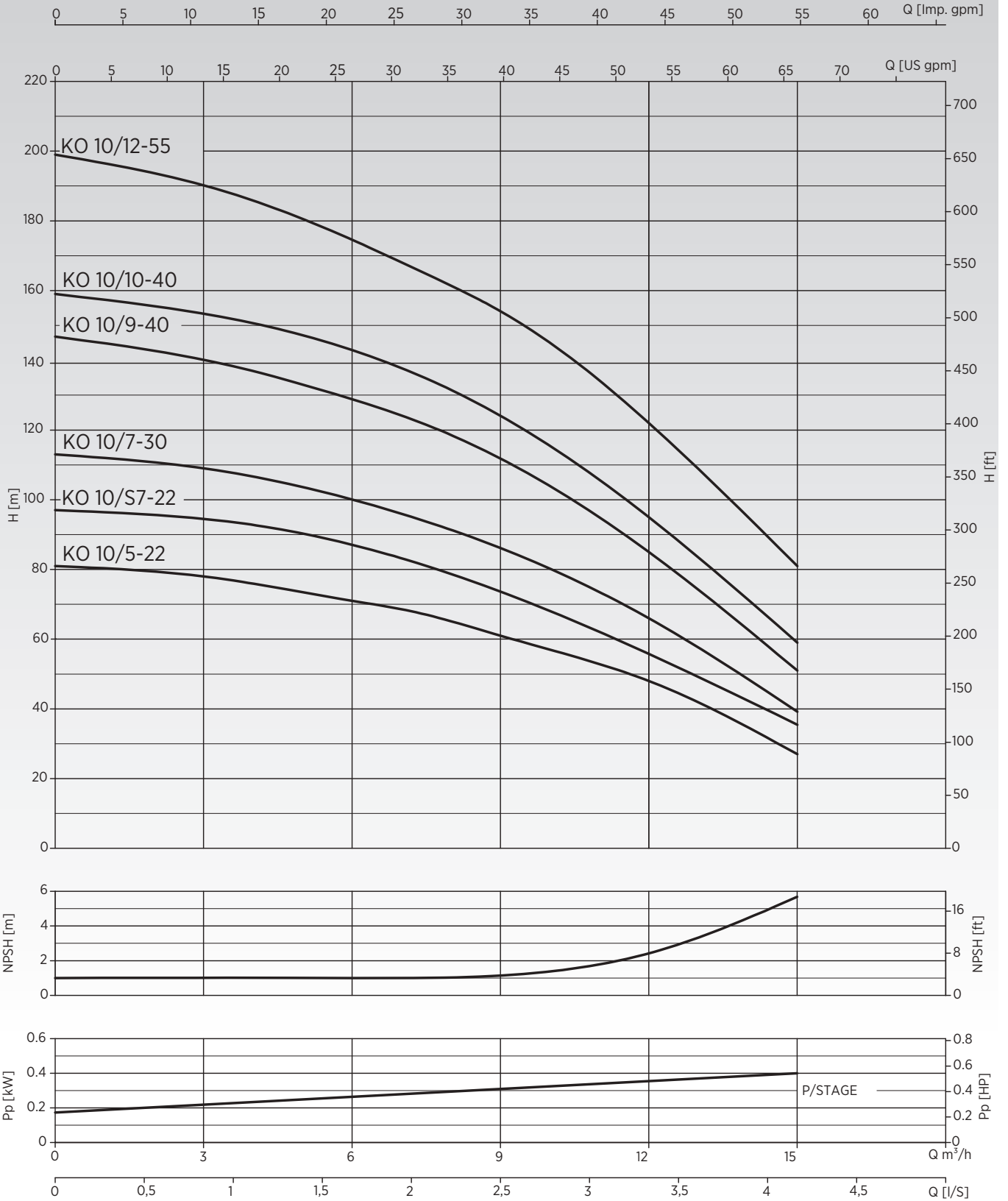



## KO 15 Series

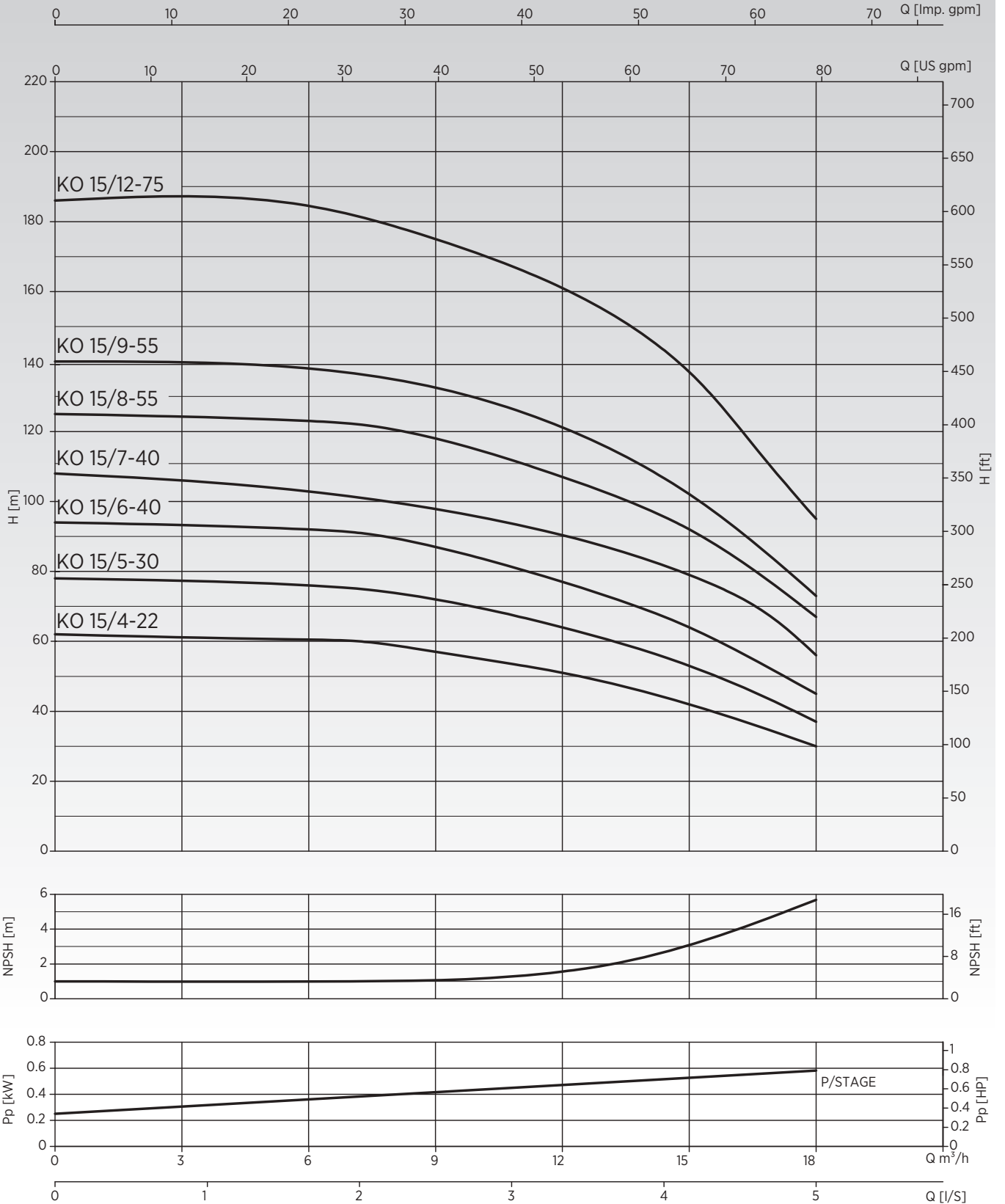

# KO Series Performance Curves

## KO 25 Series

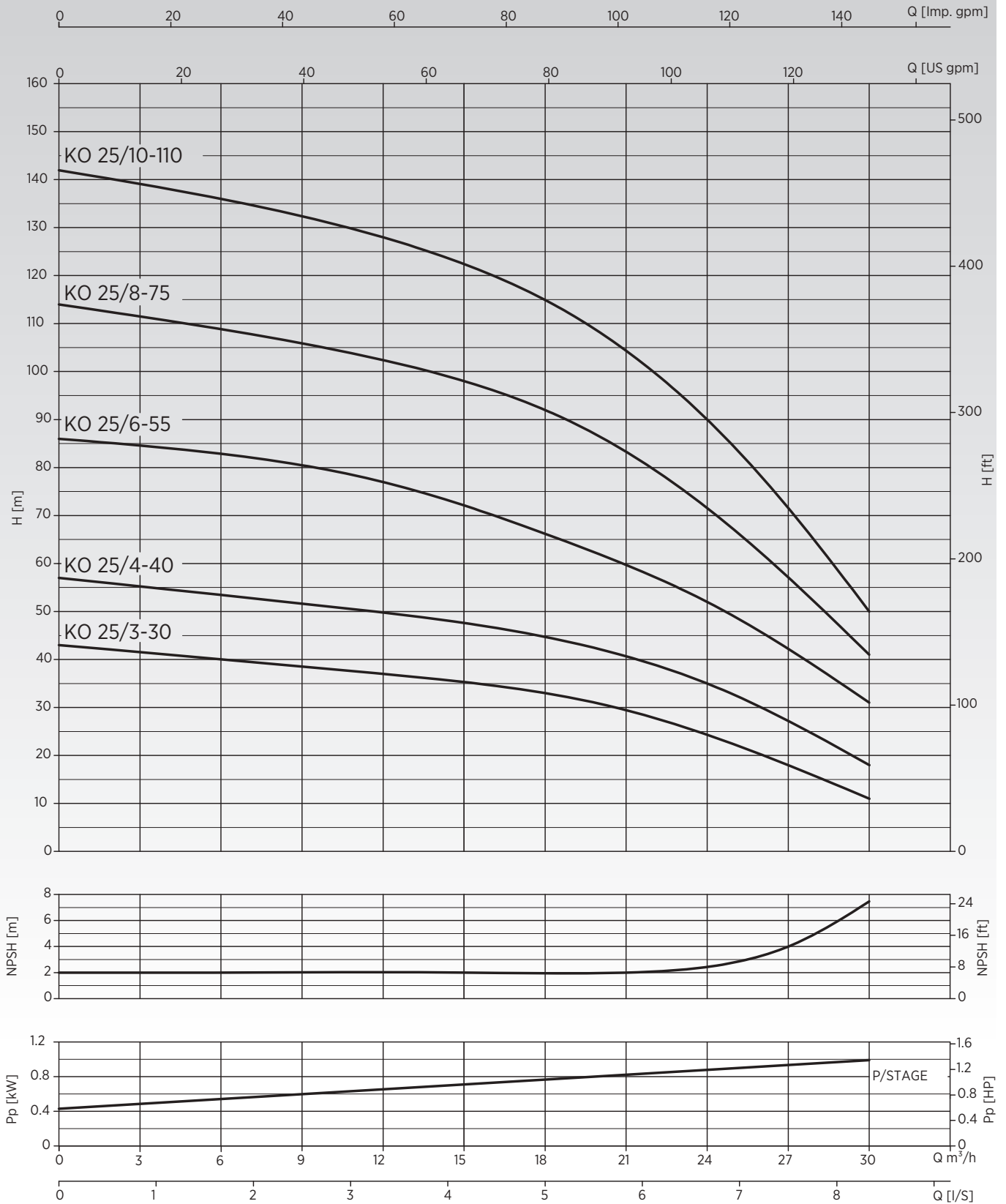



## KO 35 Series

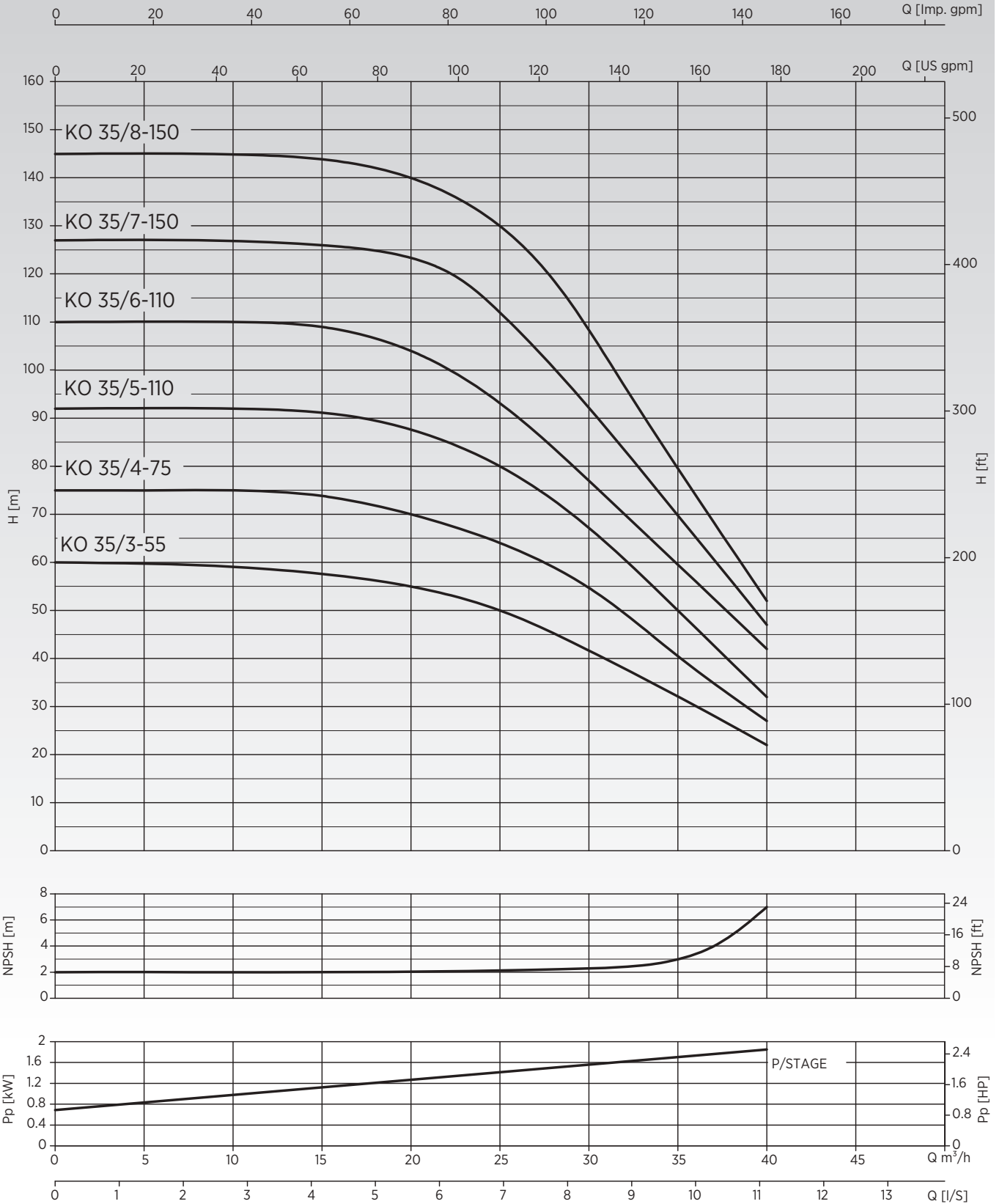

# KO Series Performance Curves

## KO 45 Series

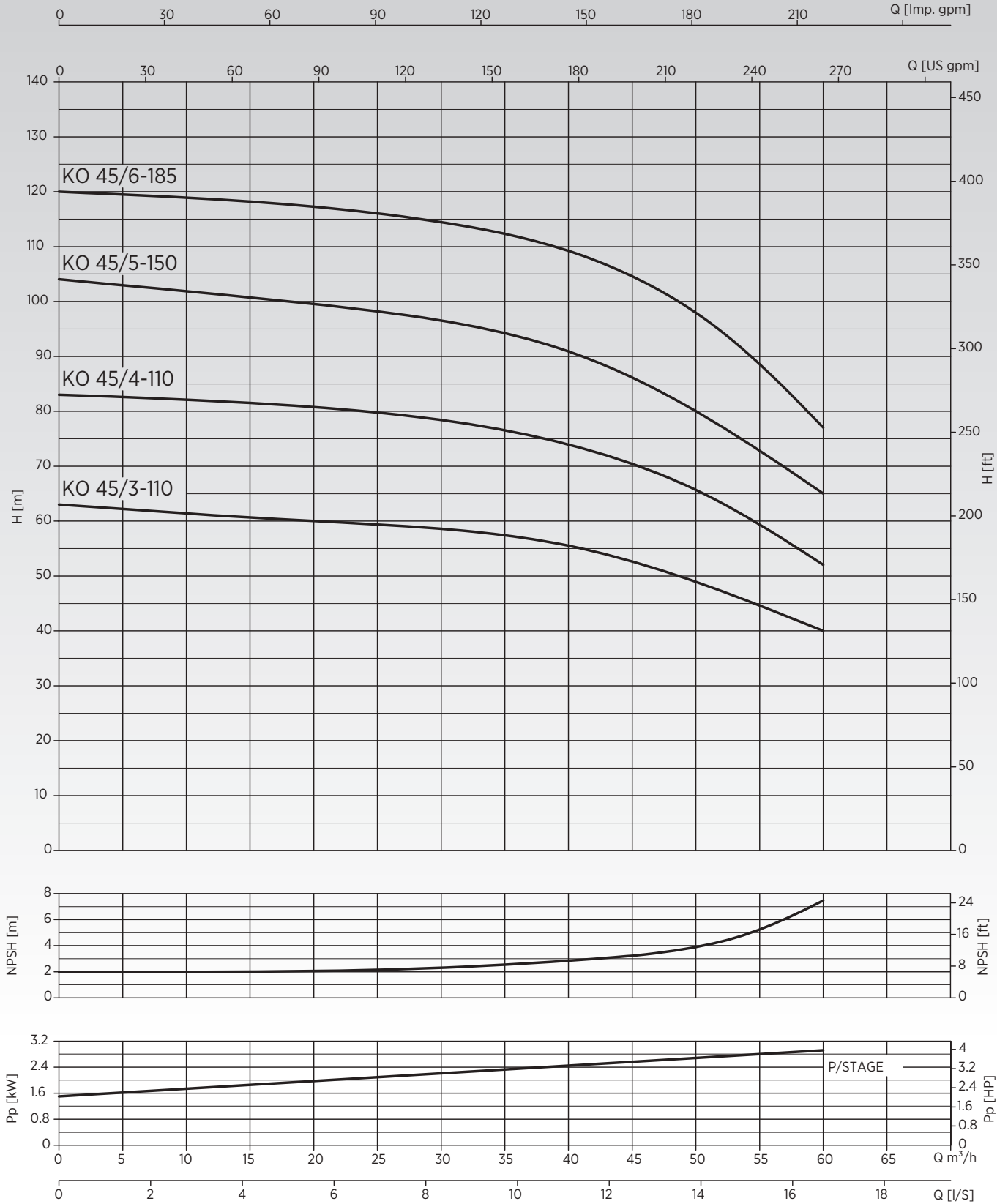

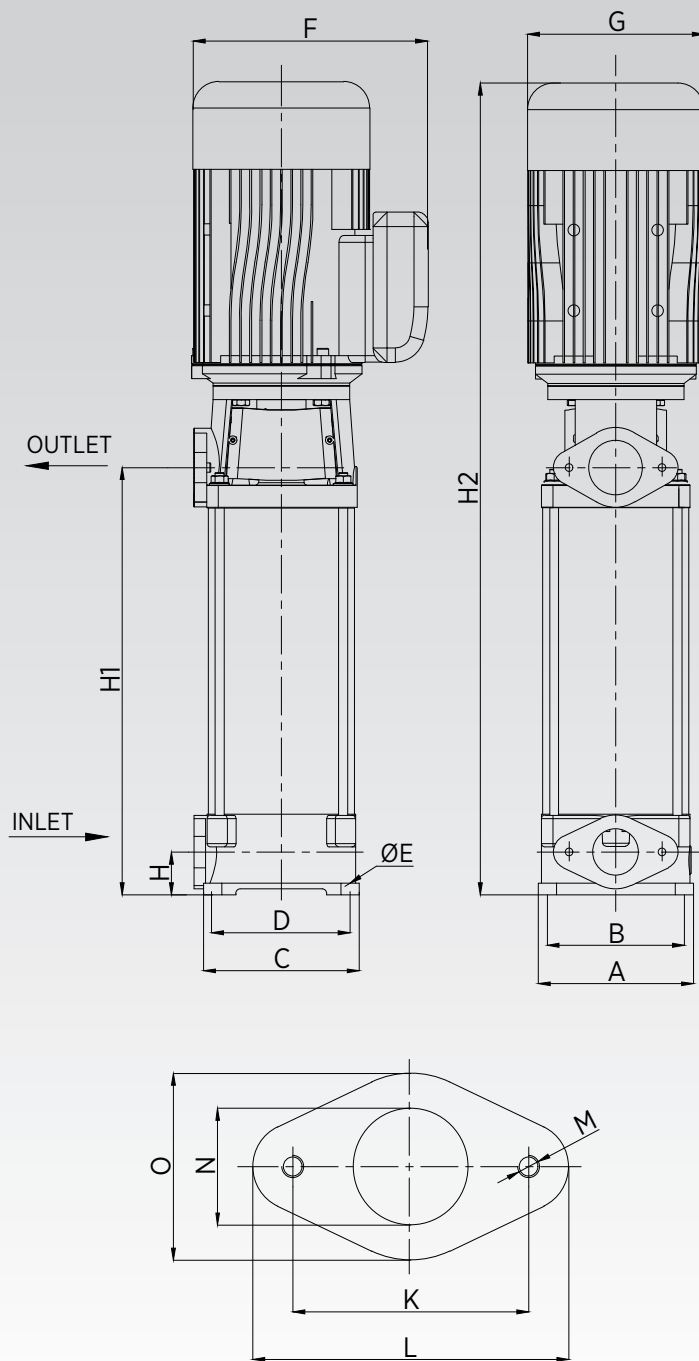

TYPE	DIMENSIONS									
	INLET					OUTLET				
	N	O	K	L	M	N	O	K	L	M
KO 4	Ø40	64	82	110	M8	Ø40	64	86	110	M8
KO 7										
KO 10	Ø42	68	88	117	M10	Ø42	68	88	117	M10
KO 15										
KO 25	Ø80	110	140	170	M12	Ø70	100	120	150	M12
KO 35										
KO 45										

# KO Series Dimensions and Weights

TYPE	DIMENSIONS												
	INLET	OUTLET	A	B	C	D	ØE	H	H1	H2	F	G	WEIGHT (kg)
KO 4/4 -0,7	1 "	1 "	137	112	137	112	10	37	223	543	200	160	20
KO 4/6 -11									271	591			18
KO 4/7 -11									295	615			19
KO 4/8 -15									319	639			21
KO 4/9 -22									343	718			220

TYPE	DIMENSIONS												
	INLET	OUTLET	A	B	C	D	ØE	H	H1	H2	F	G	WEIGHT (kg)
KO 7/6 -11	1 1/4"	1 1/4 "	137	112	137	112	10	37	271	591	200	160	18
KO 7/7 -15									295	615			20
KO 7/8 -22									319	684			24
KO 7/9 -30									343	718			27
KO 7/10 -30									367	742			220

TYPE	DIMENSIONS														
	INLET	OUTLET	A	B	C	D	ØE	H	H1	H2	F	G	WEIGHT (kg)		
KO 10/5-22	1 1/4"	1 1/4 "	153	122	153	122	12	38	322	696	220	180	22		
KO 10/S7-22									398	772			23		
KO 10/7-30									398	772			32		
KO 10/9-40									482	883			39		
KO 10/10-40									520	920			230	200	40
KO 10/12-55									596	1020			260	220	46

TYPE	DIMENSIONS														
	INLET	OUTLET	A	B	C	D	ØE	H	H1	H2	F	G	WEIGHT (kg)		
KO 15/4-22	1 1/4"	1 1/4 "	153	122	153	122	12	38	285	658	220	180	21		
KO 15/5-30									322	696			31		
KO 15/6-40									367	777			230	200	36
KO 15/7-40									402	815			37		
KO 15/8-55									443	873			43		
KO 15/9-55									482	910			260	220	44
KO 15/12-75									596	1020			54		

TYPE	DIMENSIONS														
	INLET	OUTLET	A	B	C	D	ØE	H	H1	H2	F	G	WEIGHT (kg)		
KO 25/3-30	1 1/2"	1 1/2 "	153	122	153	122	12	75	351	678	230	200	33		
KO 25/4-40									415	777			38		
KO 25/6-55									530	912			46		
KO 25/8-75									644	1020			260	220	54
KO 25/10-110									758	1140			79		

TYPE	DIMENSIONS														
	INLET	OUTLET	A	B	C	D	ØE	H	H1	H2	F	G	WEIGHT (kg)		
KO 35/3-55	2 1/2 "	2 "	175	144	175	144	12	70	348	770	260	220	46		
KO 35/4-75									394	816			54		
KO 35/5-110									439	960			320	300	78
KO 35/6-110									485	1005			80		
KO 35/7-150									531	1155			380	310	114
KO 35/8-150									576	1200			115		

TYPE	DIMENSIONS														
	INLET	OUTLET	A	B	C	D	ØE	H	H1	H2	F	G	WEIGHT (kg)		
KO 45/3-110	3"	2 1/2 "	175	144	175	144	12	70	431	950	320	300	77		
KO 45/4-110									493	1010			79		
KO 45/5-150									575	1200			380	310	114
KO 45/6-185									637	1260			115		



## KO ST Series

High quality pumps with compact construction and high efficiency with AISI304 grade stainless steel on all water contact surfaces. Highly preferred with its small footprint in booster systems and connection style as overlaying ( inlet at the bottom and outlet at top) occupying space at floor.

### Fields of Use

- Pressurized water supply in residential and commercial buildings
- Garden irrigation systems
- As booster pumps in commercial & residential buildings
- Clean water transfer

### Pump Specifications

- Pump Body : AISI 304 Stainless Steel
- Impeller & Diffuser : AISI 304 Stainless Steel
- Pump Shaft : AISI 420 Stainless Steel
- Mechanical Seal : Carbon / Ceramic / EPDM

### Technical Specifications

- Maximum Flow : 28 m<sup>3</sup>/h
- Maximum Pressure : 240 mwc
- Inlet-Outlet Diameter : 1" & 2"
- Pressure Class : PN25
- Max. Ambient Temperature : 40°C
- Fluid Temperature : 0 - 100°C
- Fluid Property : Clean, solid particle-free, chemically neutral water
- Motor Speed : 2900 rpm
- Network Connection : 3\*380V, 50Hz
- Motor Power : 0,75 - 18,5 Kw
- Protection Class : IP55
- Insulation Class : F

## Identification Code

**KO ST 12 / 11 / 75**

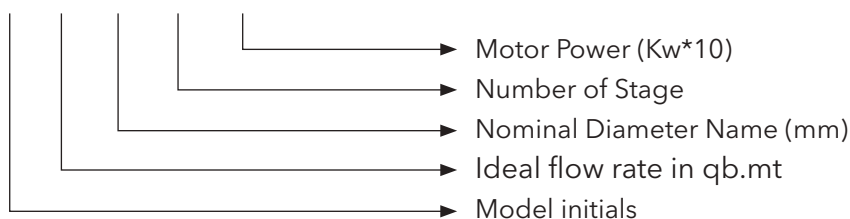

# KO ST Series Family Curves

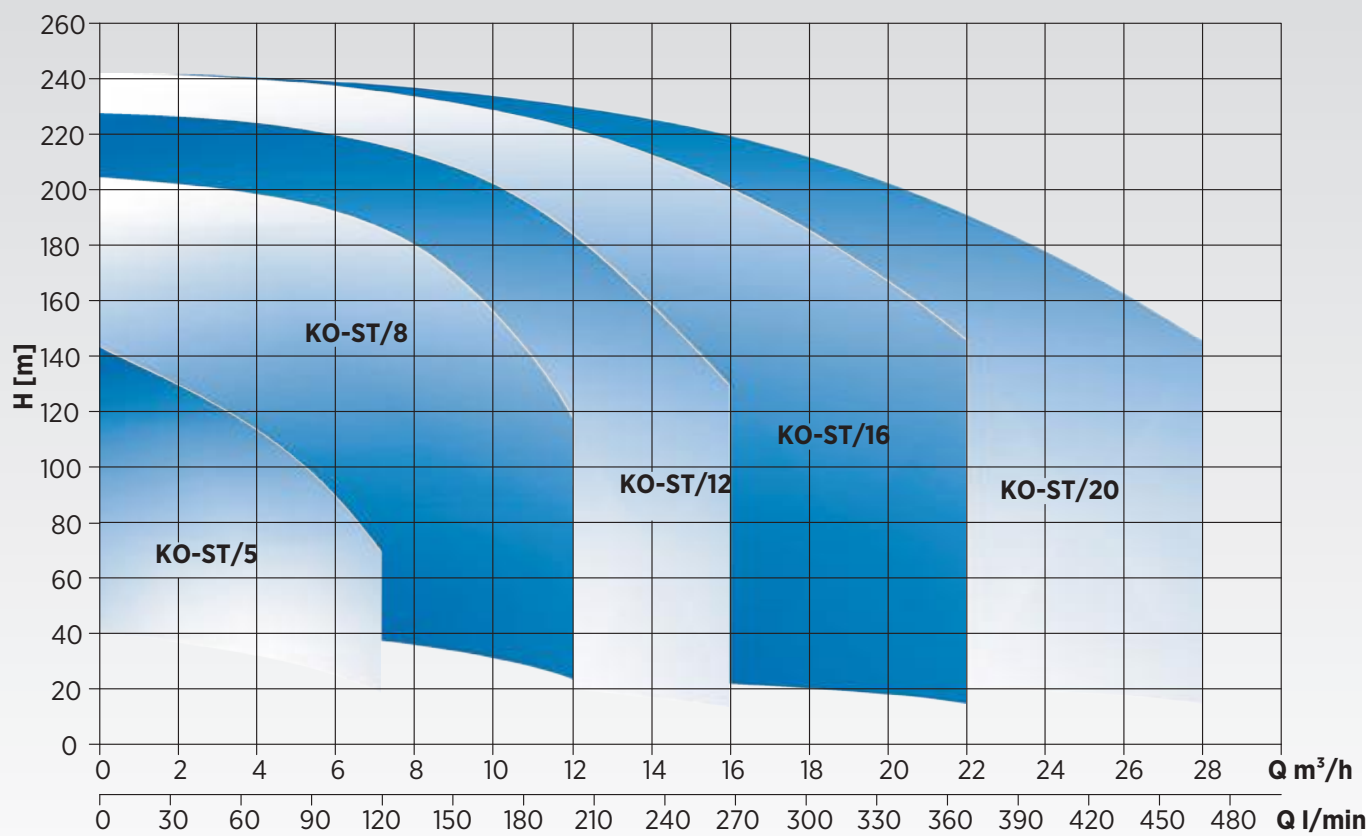



## KO ST 5 Series

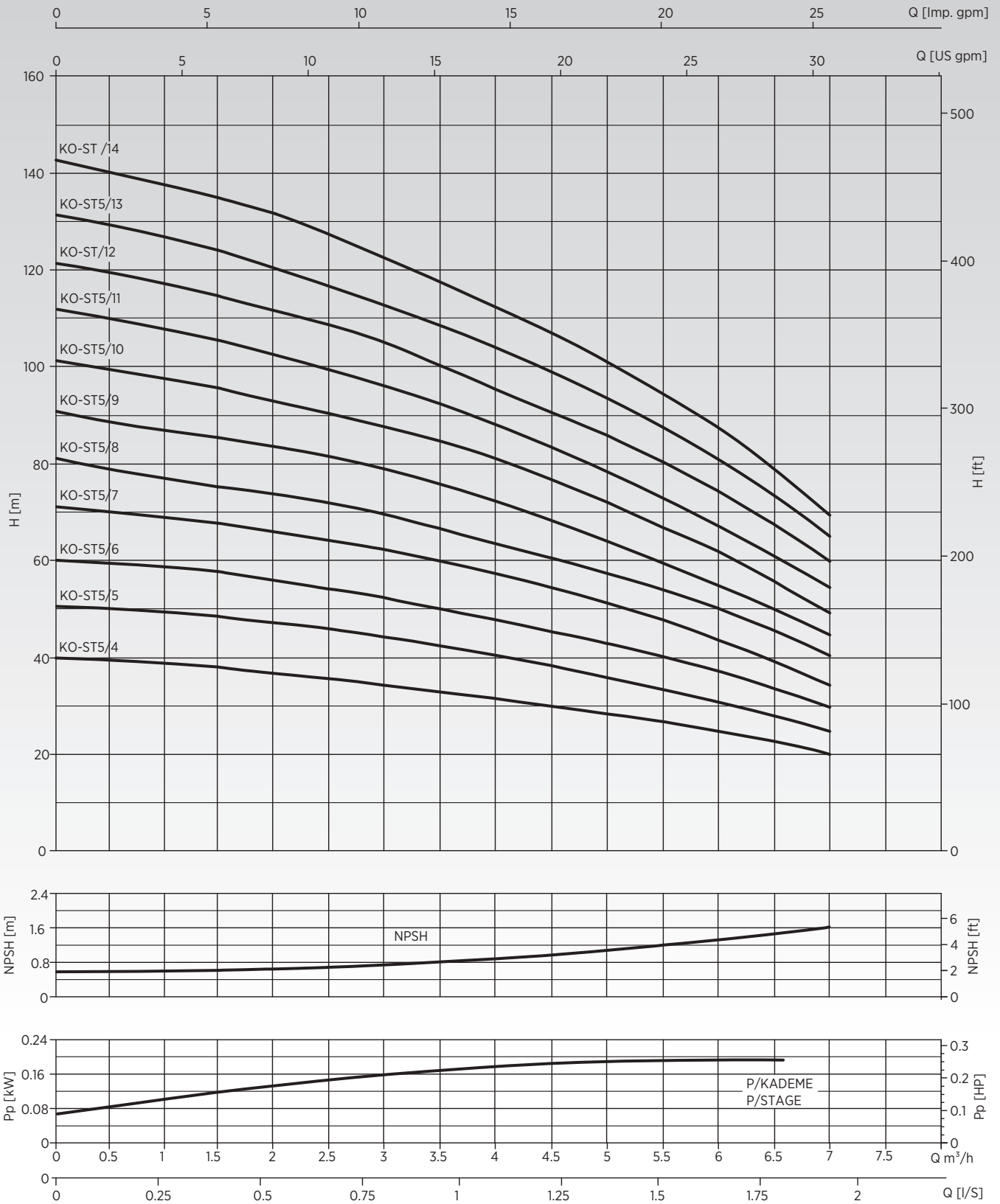

# KO ST Series Performance Curves

## KO ST 8 Series

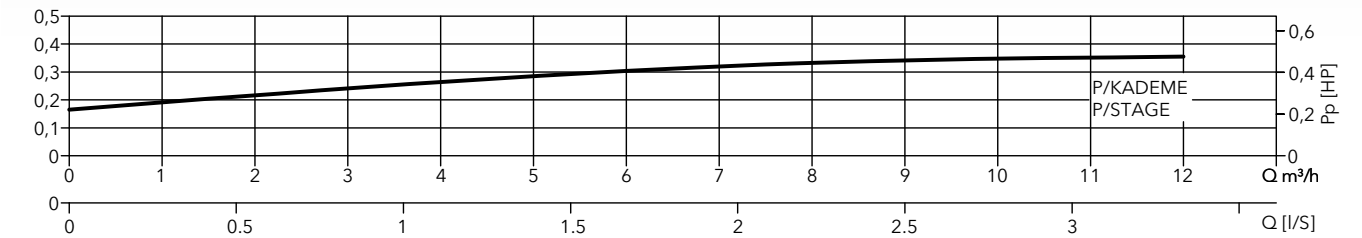
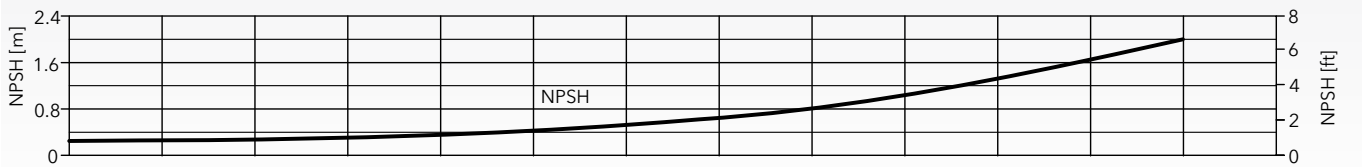
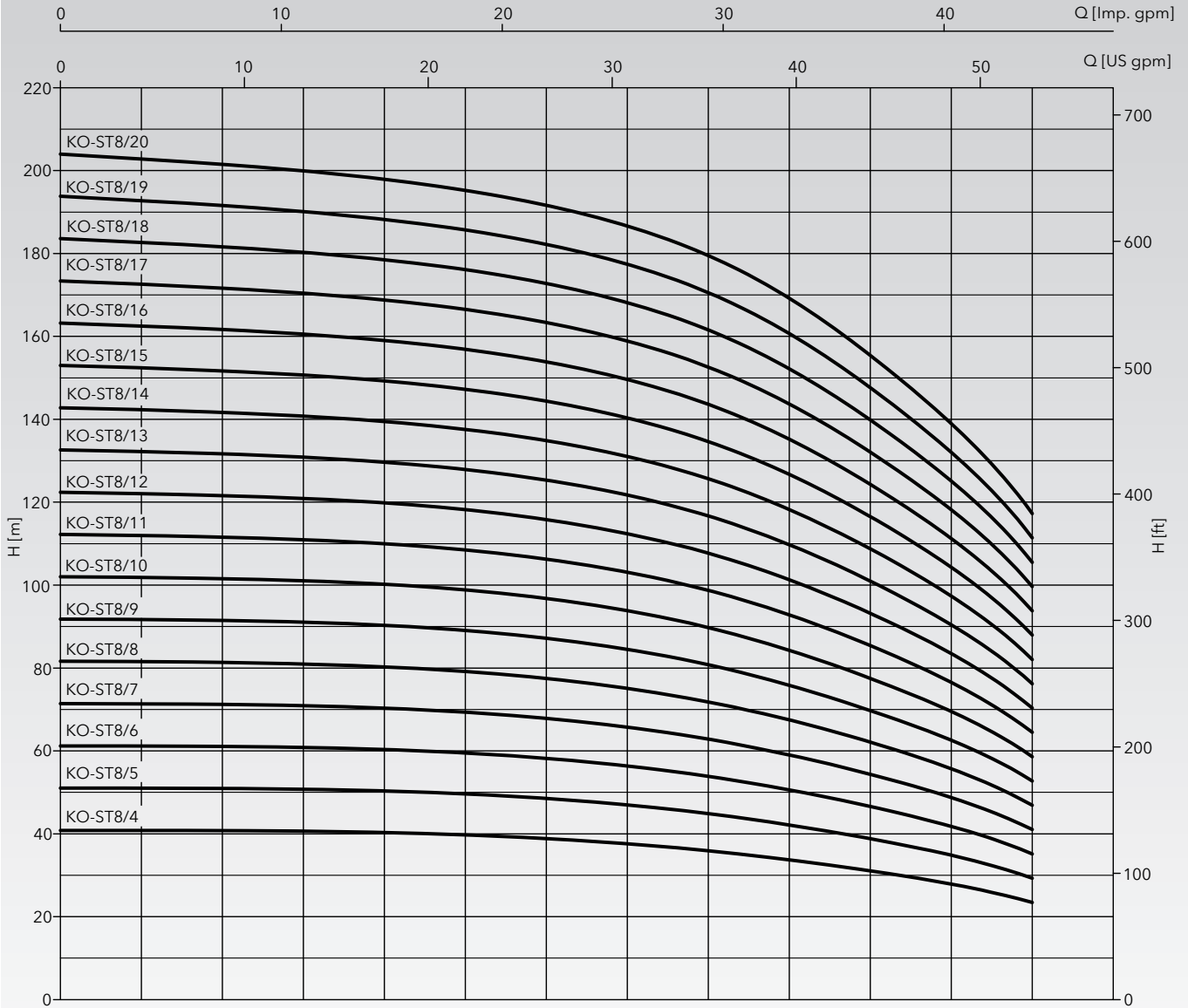



## KO ST 12 Series

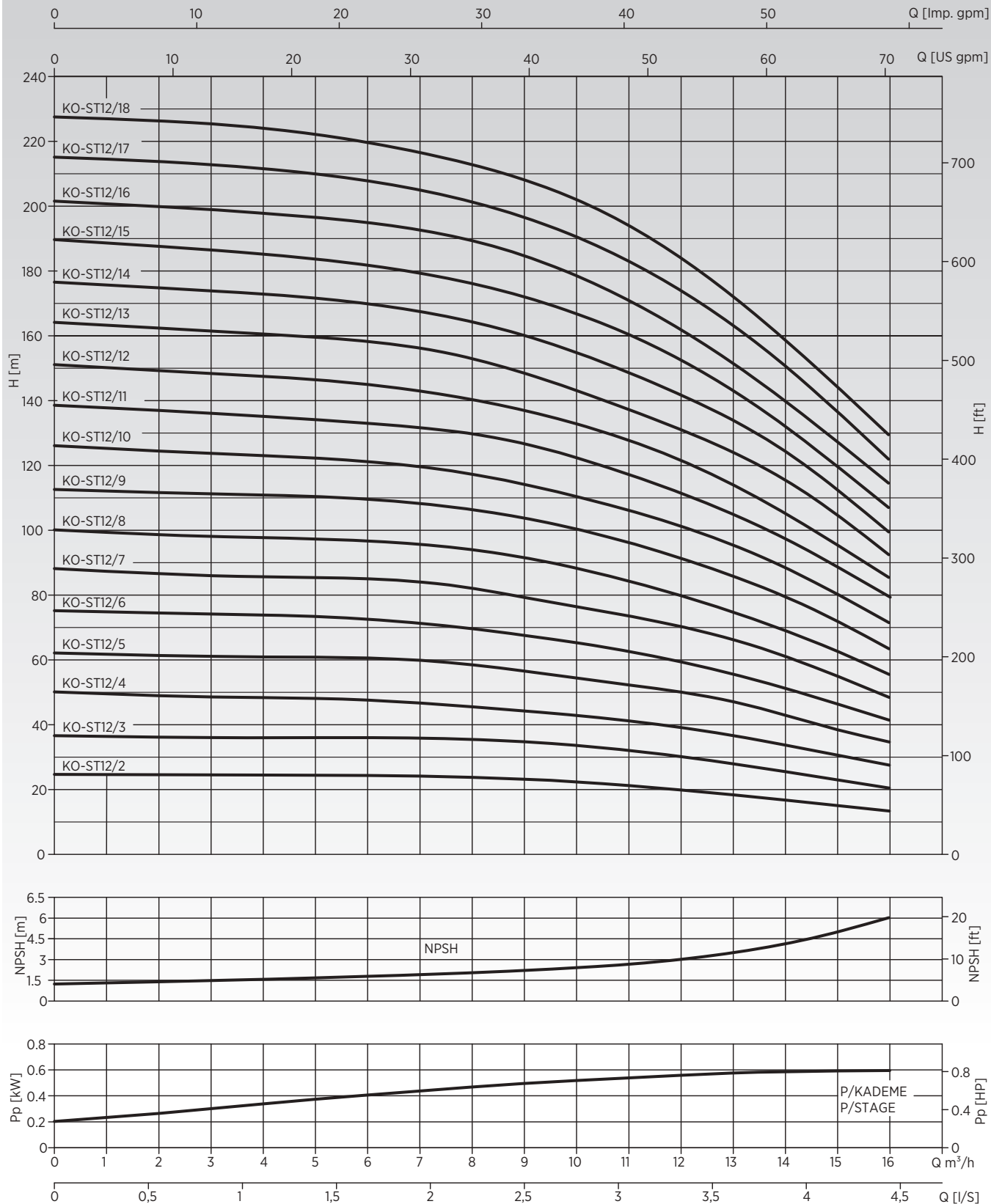

# KO ST Series Performance Curves

## KO ST 16 Series

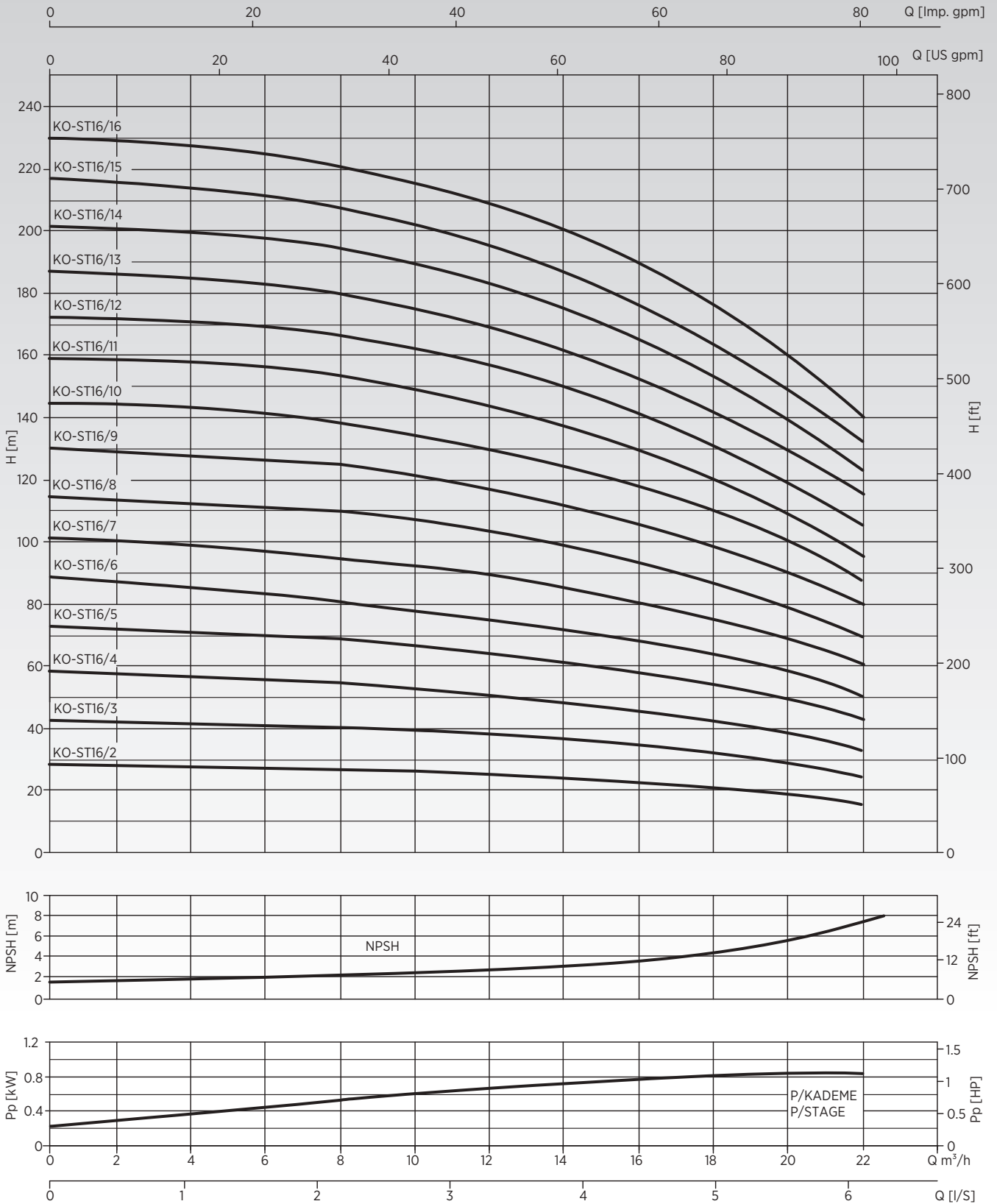

## KO ST 20 Series

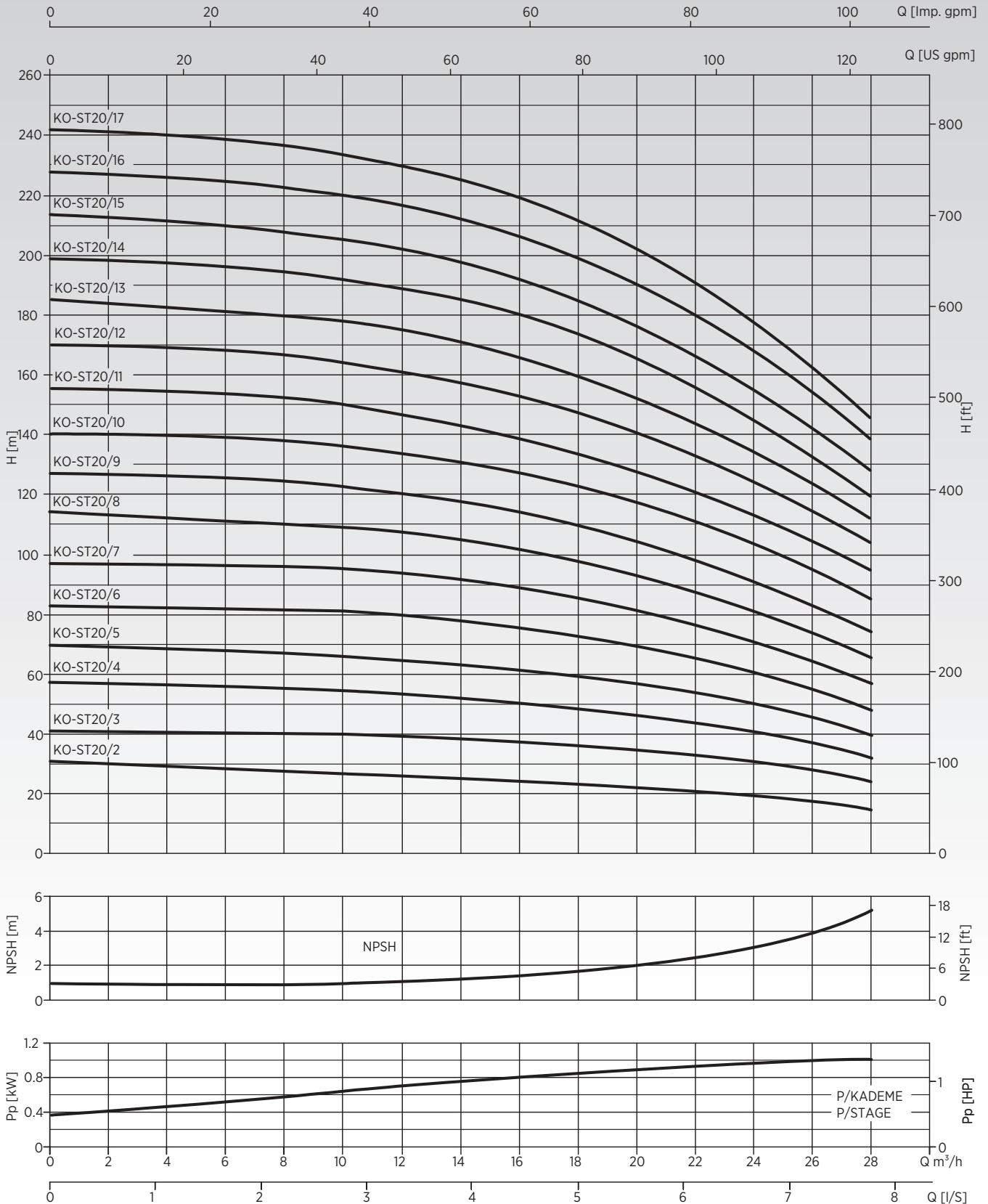

# KO ST Series Dimensions and Weights

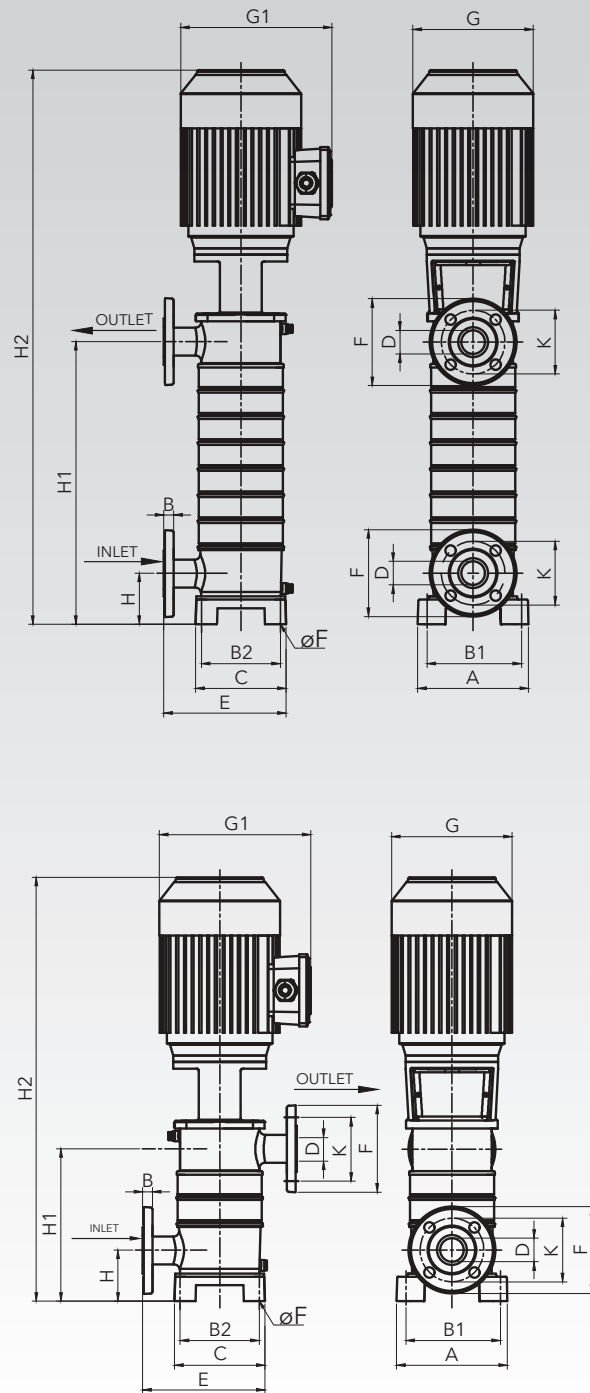

TYPE	DIMENSIONS			
	E	K	F	B
KO-ST-5	27	90	108	10
KO-ST-8	55	120	143	10
KO-ST-12	55	120	143	10
KO-ST-16	55	120	143	10
KO-ST-20	55	120	143	10

TYPE	DIMENSIONS													
	Inlet	Out	A	B1	C	B2	E	ØF	H	H1	H2	G	G1	Weight
KO-ST5/4-075	1"	1"	151	128	121	64	173	9	68	224	578	156	196	18
KO-ST5/5-11										251	600			20
KO-ST5/6-11										278	632			20
KO-ST5/7-15										305	659			22
KO-ST5/8-15										332	686	22		
KO-ST5/9-22										359	768	27		
KO-ST5/10-22										386	795	28		
KO-ST5/11-22										413	822	28		
KO-ST5/12-22										440	849	29		
KO-ST5/13-30										467	876	33		
KO-ST5/14-30										494	903	33		

TYPE	DIMENSIONS													
	Inlet	Out	A	B1	C	B2	E	ØF	H	H1	H2	G	G1	Weight
KO-ST8/4-15	1 1/2"	1 1/2"	190	156	155	96	197	13	87	260	690	176	214	26
KO-ST8/5-22										290	720			31
KO-ST8/6-22										320	750			32
KO-ST8/7-30										350	780			36
KO-ST8/8-30										380	810	37		
KO-ST8/9-40										410	880	46		
KO-ST8/10-40										440	910	47		
KO-ST8/11-40										470	940	47		
KO-ST8/12-55										500	970	56		
KO-ST8/13-55										530	1000	57		
KO-ST8/14-55										560	1030	58		
KO-ST8/15-55										590	1060	59		
KO-ST8/16-75										620	1090	75		
KO-ST8/17-75										650	1120	76		
KO-ST8/18-75										680	1150	76		
KO-ST8/19-75										710	1180	77		
KO-ST8/20-75										740	1210	78		

TYPE	DIMENSIONS													
	Inlet	Out	A	B1	C	B2	E	ØF	H	H1	H2	G	G1	Weight
KO-ST12/2-15	1 1/2"	1 1/2"	190	156	155	96	197	13	87	200	630	156	196	24
KO-ST12/3-22										230	660			29
KO-ST12/4-30										260	690			34
KO-ST12/5-30										290	720			34
KO-ST12/6-40										320	790	43		
KO-ST12/7-55										350	820	52		
KO-ST12/8-55										380	850	53		
KO-ST12/9-55										410	880	54		
KO-ST12/10-75										440	910	70		
KO-ST12/11-75										470	940	70		
KO-ST12/12-75										500	970	71		

TYPE	DIMENSIONS													
	Giriş / Inlet	Çıkış / Out	A	B1	C	B2	E	ØF	H	H1	H2	G	G1	Weight
Ç-ST16/2-22	1 1/2"	1 1/2"	190	156	155	96	197	13	87	215	645	176	214	29
Ç-ST16/3-30										260	690			33
Ç-ST16/4-40										305	775			43
Ç-ST16/5-55										350	820			52
Ç-ST16/6-55										395	865	53		
Ç-ST16/7-75										440	910	70		
Ç-ST16/8-75										485	955	71		
Ç-ST16/9-75										530	1000	72		
Ç-ST16/10-110										575	1160	87		
Ç-ST16/11-110										620	1200	89		
Ç-ST16/12-110										665	1240	90		

TYPE	DIMENSIONS													
	Inlet	Out	A	B1	C	B2	E	ØF	H	H1	H2	G	G1	Weight
O-ST20/2-22	1 1/2"	1 1/2"	190	156	155	96	197	13	87	215	645	176	214	29
O-ST20/3-40										260	730			41
O-ST20/4-55										305	775			51
O-ST20/5-55										350	820	52		
O-ST20/6-75										395	865	68		
O-ST20/7-75										440	910	70		
O-ST20/8-110										485	1070	85		
O-ST20/9-110										530	1120	86		
O-ST20/10-110										575	1160	87		
O-ST20/11-110										620	1200	89		

# Completely Stainless Steel, Vertical Multi-Stage Centrifugal Pumps



## KI Series

High quality pumps with compact construction and high efficiency with AISI304 grade stainless steel on all water contact surfaces. Features in-line (on the same axis) inlet-outlet connections.

### Fields of Use

- Pressurized water supply in residential and commercial buildings
- Garden irrigation systems
- Agricultural irrigation systems
- Industrial applications
- Water treatment systems
- Clean water transfer

### Pump Specifications

- Pump Body : AISI 304 Stainless Steel
- Impeller & Diffuser : AISI 304 Stainless Steel
- Pump Shaft : AISI 304 Stainless Steel
- Mechanical Seal : Carbon / Ceramic / EPDM

### Technical Specifications

- Maximum Flow : 28 m<sup>3</sup>/h
- Maximum Pressure : 240 mwc
- Inlet-Outlet Diameter : DN25 & DN50
- Pressure Class : PN25
- Max. Ambient Temperature : 40°C
- Fluid Temperature : 0 - 100°C
- Fluid Property : Clean, solid particle-free, chemically neutral water
- Motor Speed : 2900 rpm
- Network Connection : 3\*380V - 50 Hz
- Motor Power : 0,75 - 18,5 Kw
- Protection Class : IP55
- Insulation Class : F

## Identification Code

**KI 5 / 11 / 22**

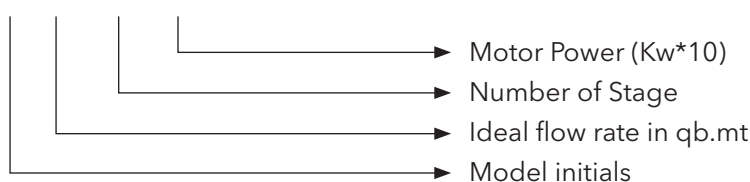

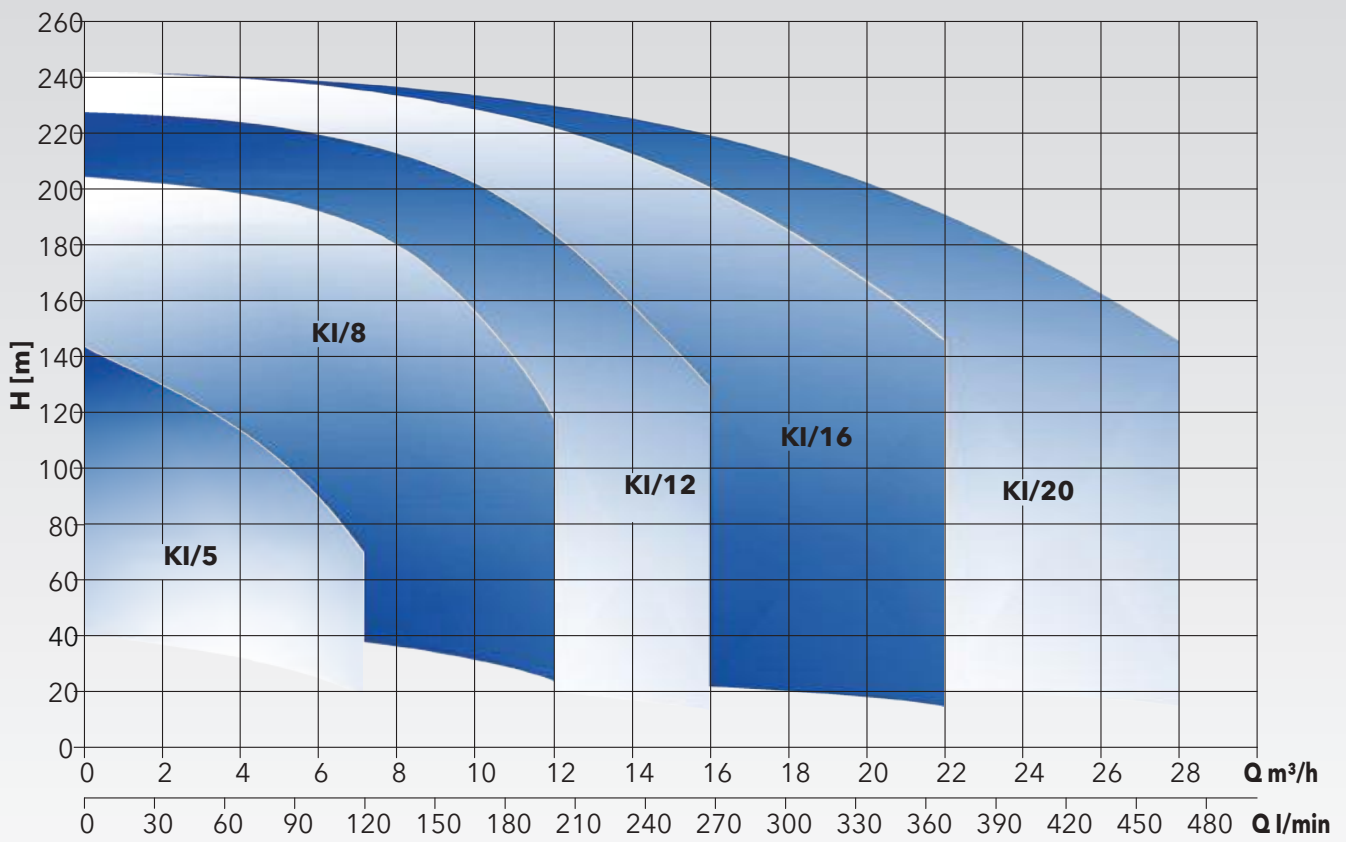

# KI Series Performance Curves

## KI 5 Series

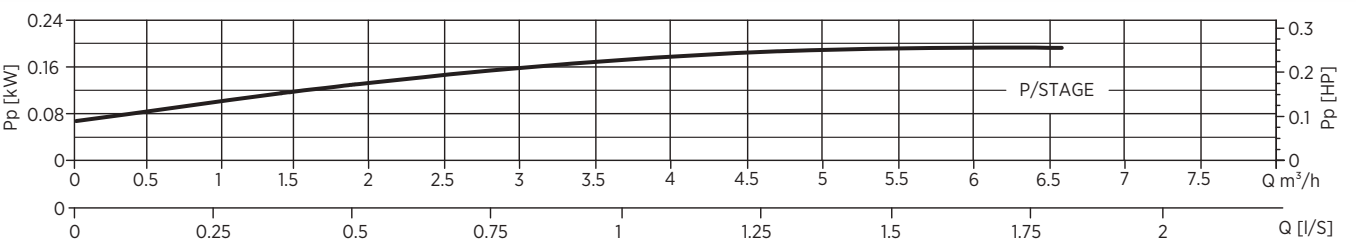
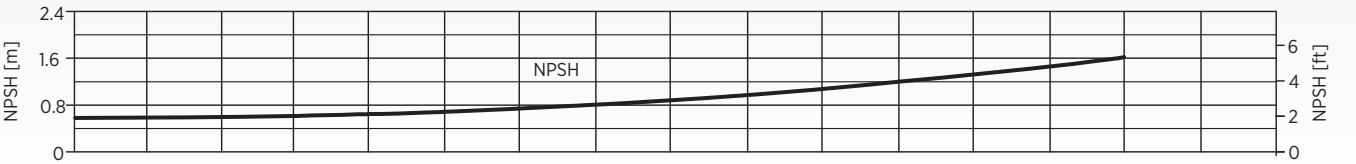
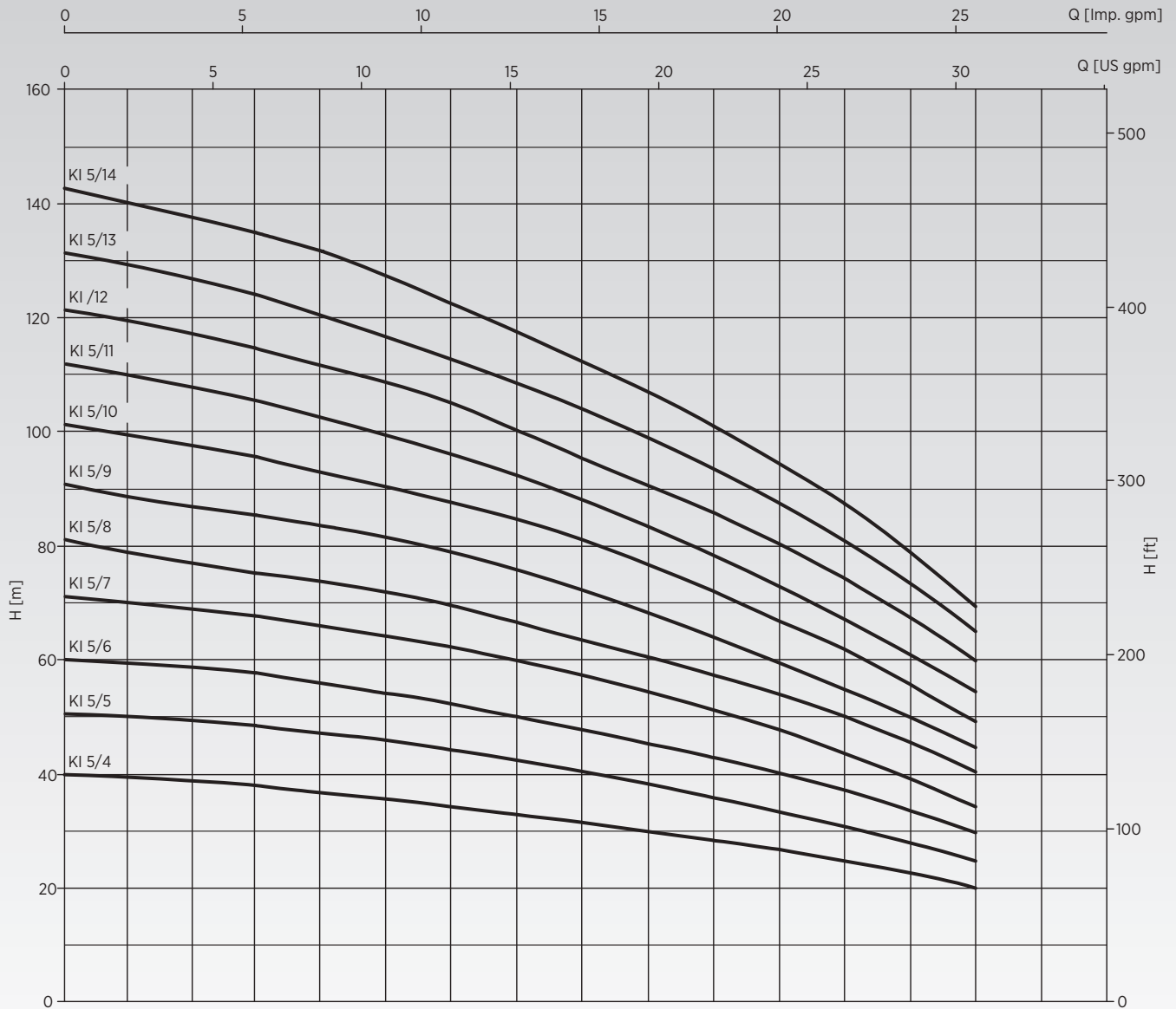





KI 8 Series

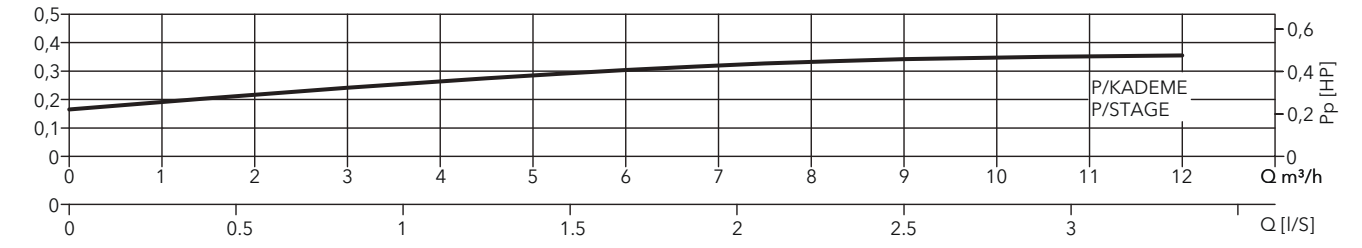
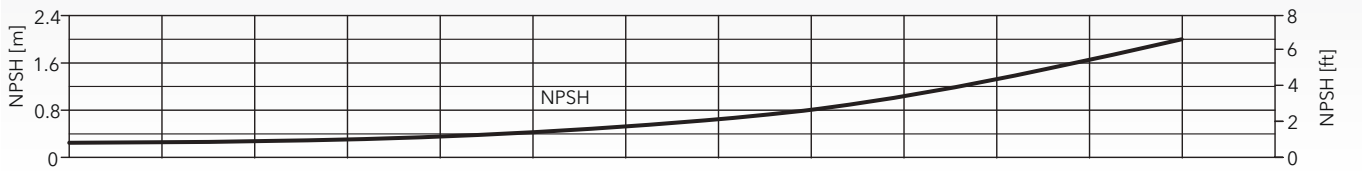
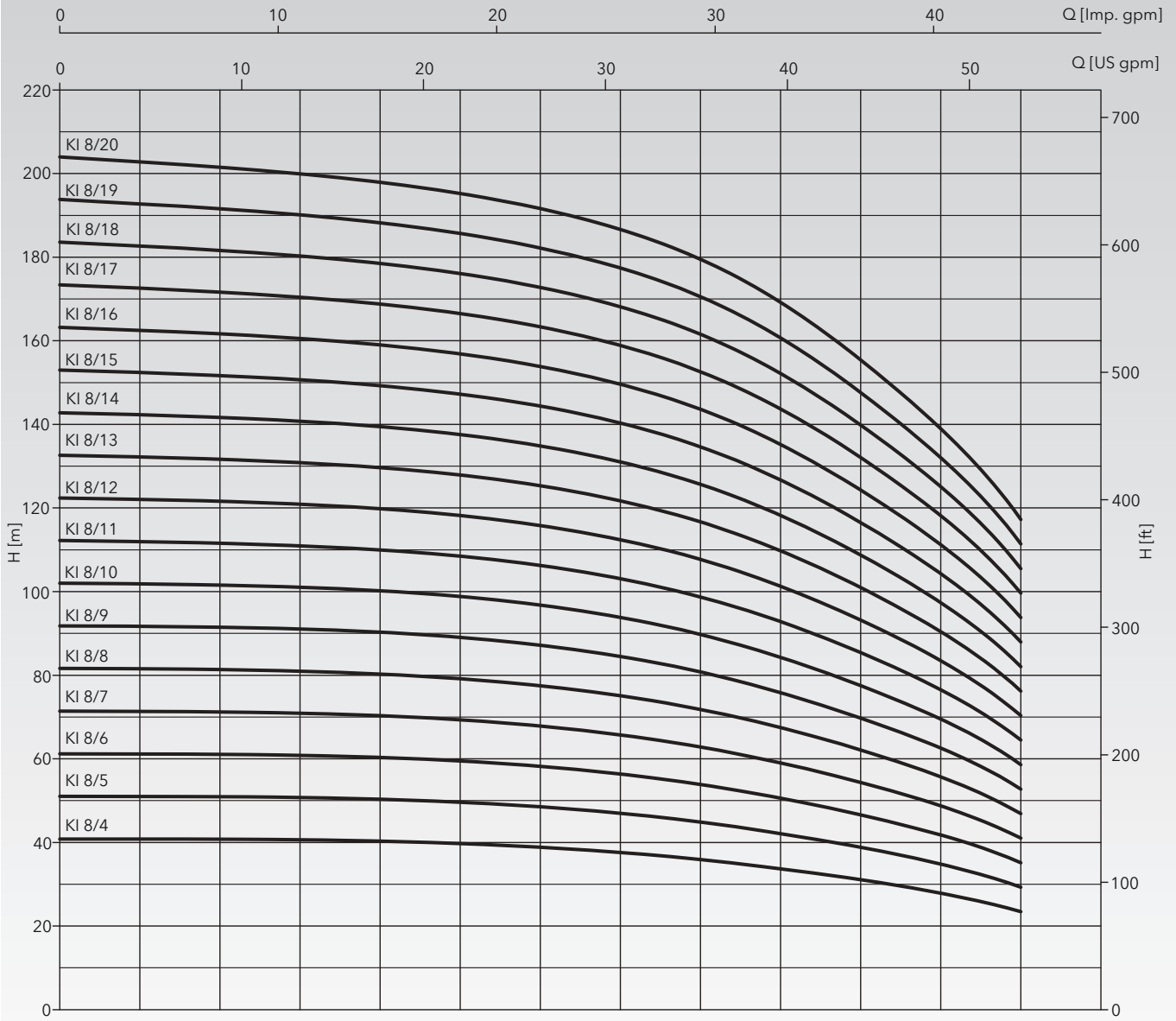

# KI Series Performance Curves

## KI 12 Series

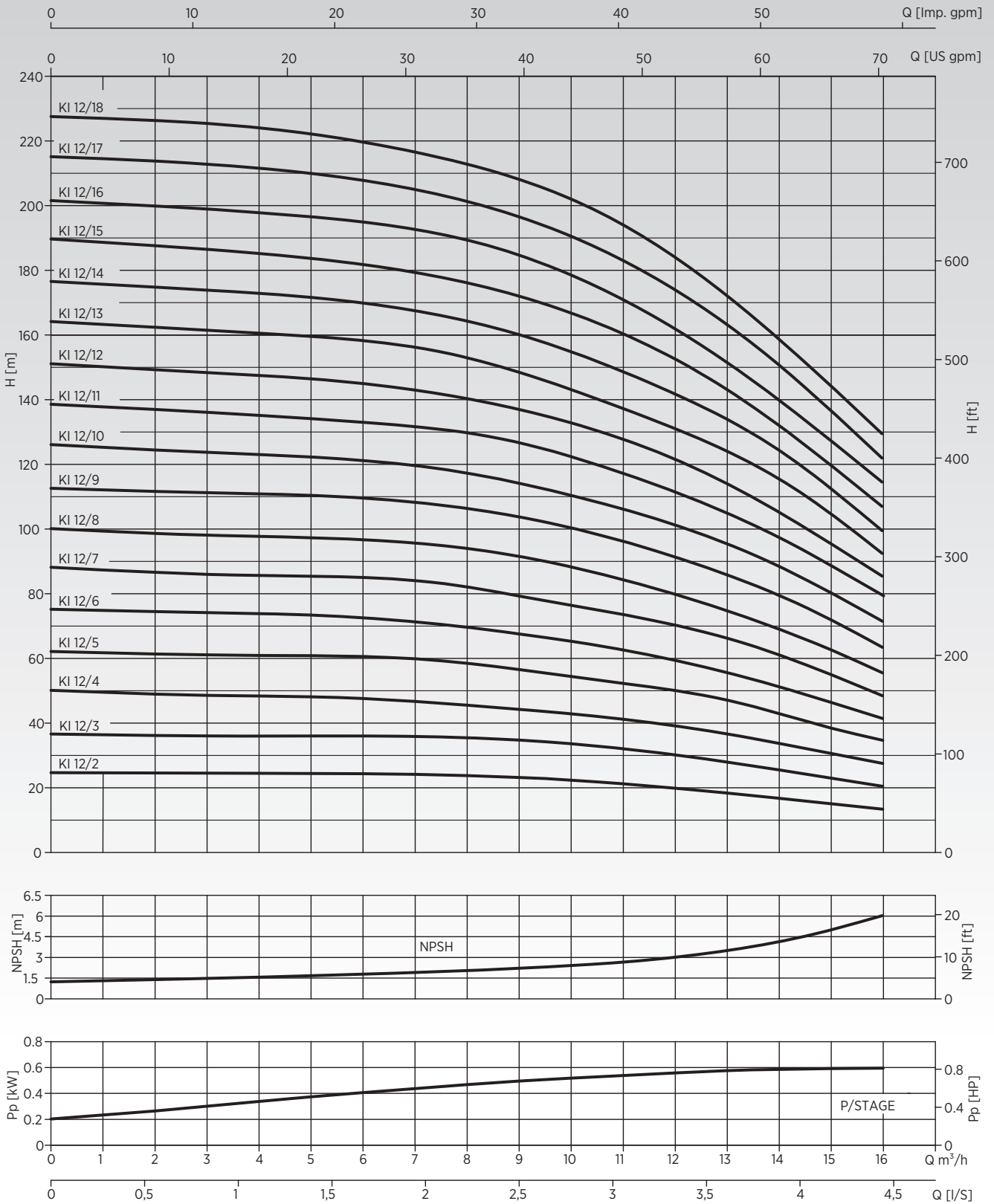

## KI 16 Series

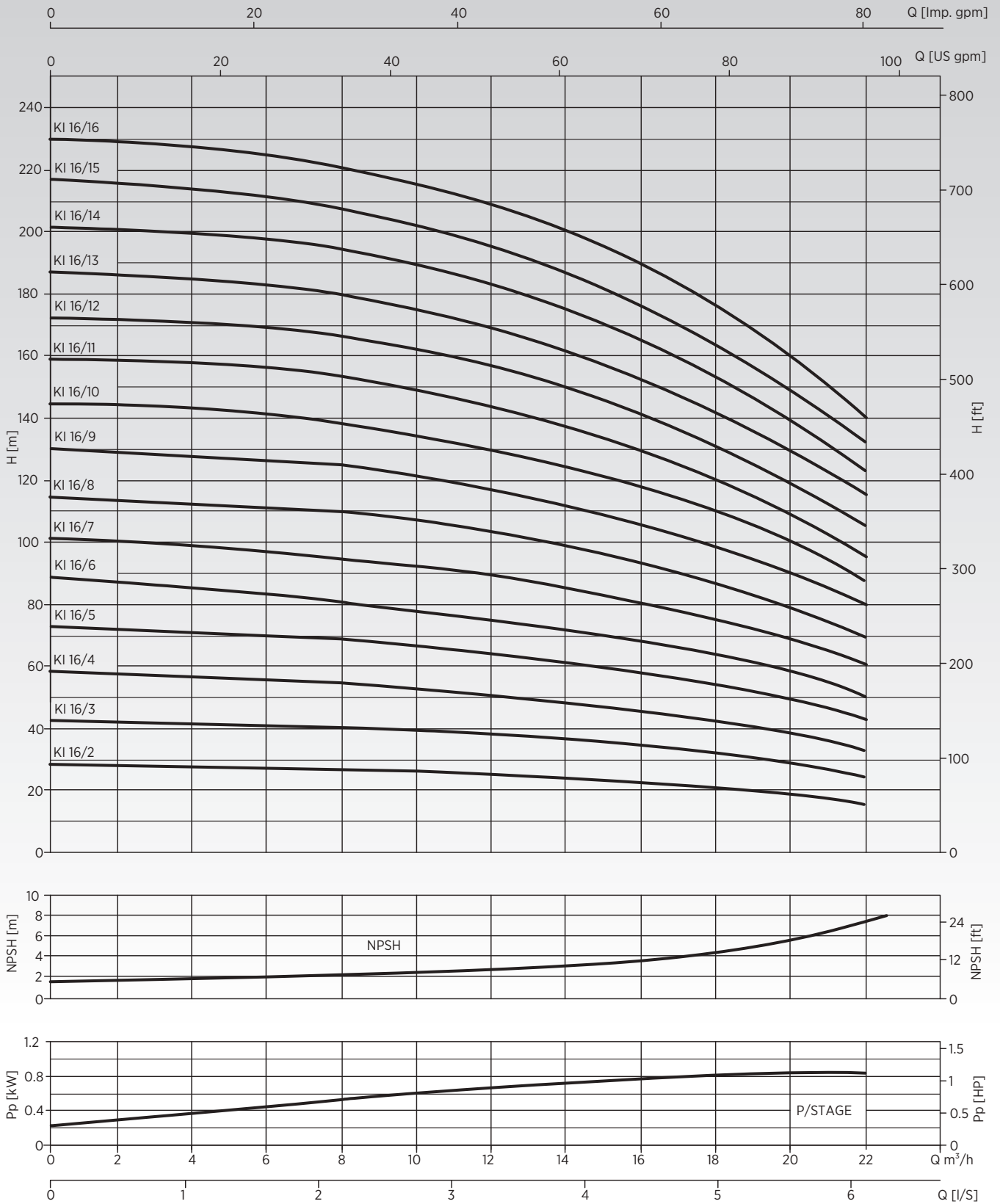

# KI Series Performance Curves

## KI 20 Series

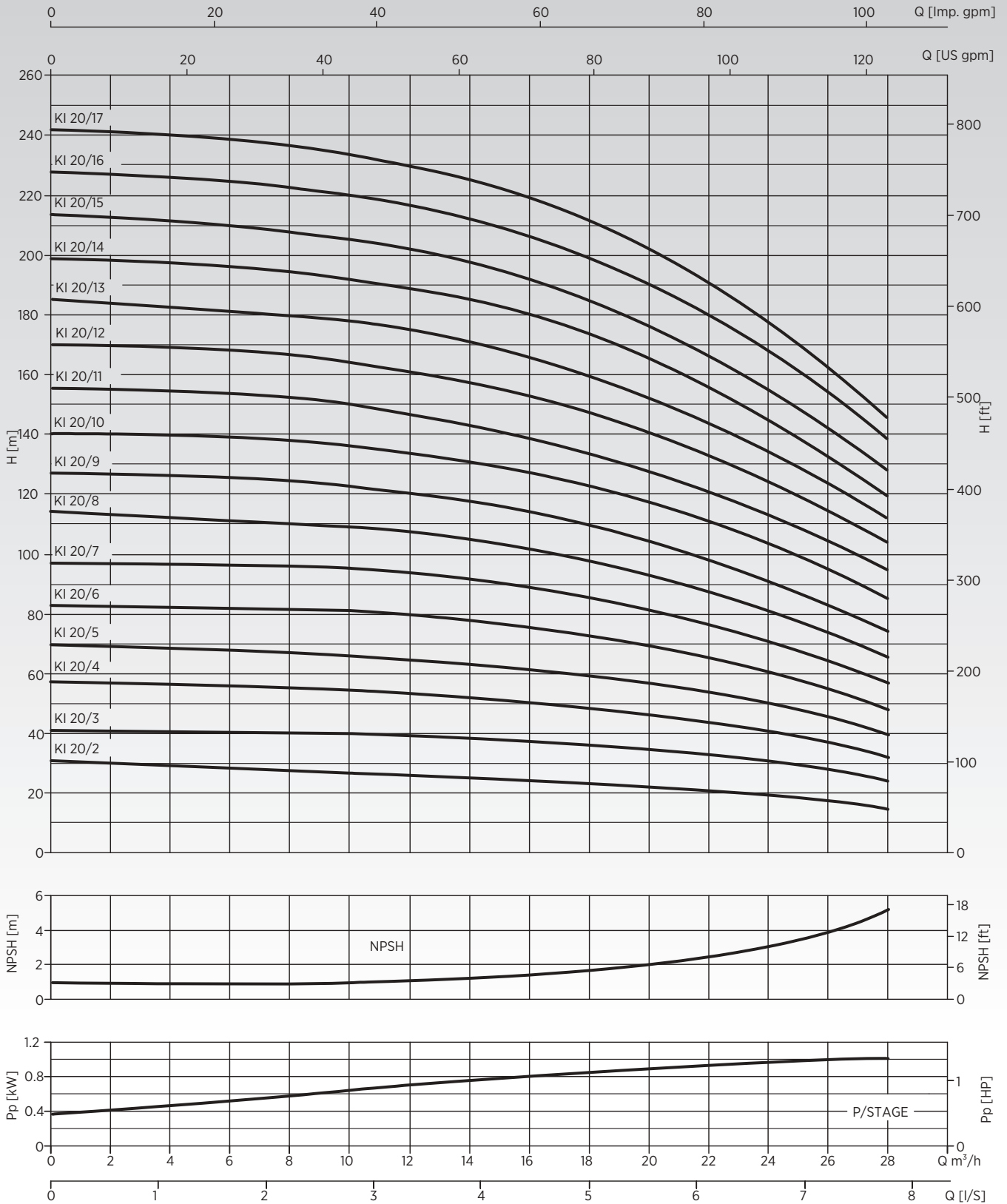

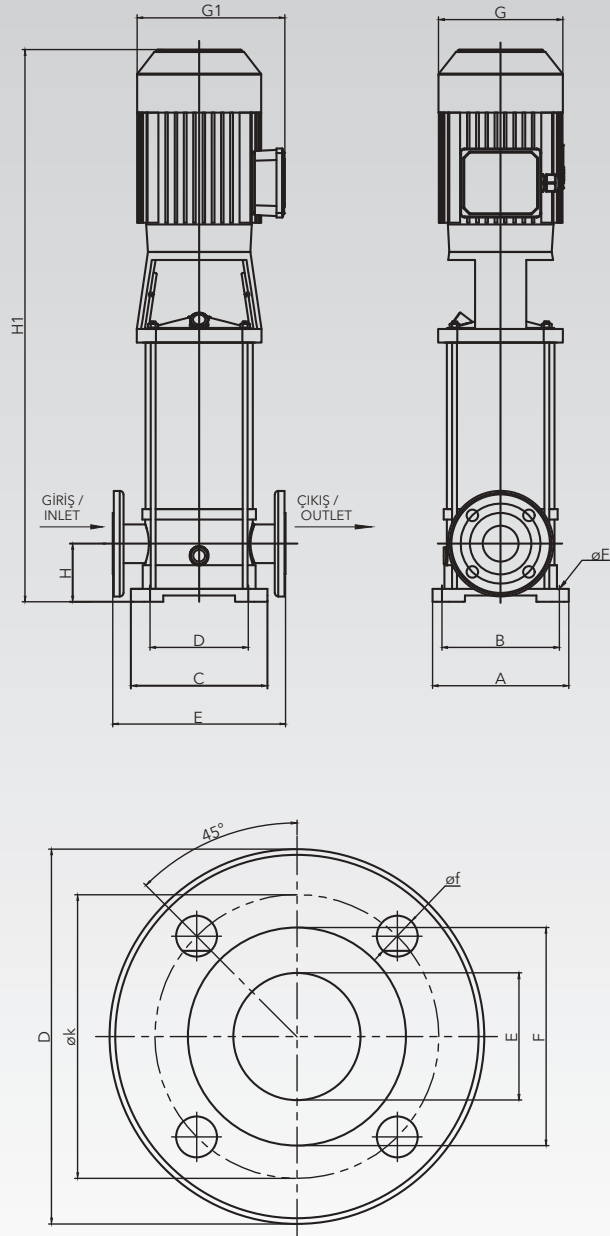

MODEL TYPE	ÖLÇÜLER / DIMENSIONS					
	D	øk	E	F	øf	Delik Sayısı Hole Pieces
KI 5	115	85	27	50	14	4
KI 8	150	110	40	84	18	4
KI 12	150	110	40	84	18	4
KI 16	150	110	40	84	18	4
KI 20	150	110	40	84	18	4

# KI Series Dimensions

TYPE	DIMENSIONS												
	Inlet	Out	A	B	C	D	E	ØF	H	H1	G	G1	Weight
KI 5/4-075	DN25	DN25	190	160	147	90	248	10	85	578	156	196	19
KI 5/5-11										605			21
KI 5/6-11										632			22
KI 5/7-15										714	176	216	23
KI 5/8-15										741			24
KI 5/9-22										768			29
KI 5/10-22										795			29
KI 5/11-22										822			30
KI 5/12-22										849			31
KI 5/13-30										918			194
KI 5/14-30										942	36		

TYPE	DIMENSIONS												
	Inlet	Out	A	B	C	D	E	ØF	H	H1	G	G1	Weight
KI 8/4-15	DN40	DN40	220	184	190	110	285	13	115	710	176	216	30
KI 8/5-22										740			35
KI 8/6-22										770			36
KI 8/7-30										800			41
KI 8/8-30										872	194	231	42
KI 8/9-40										902			51
KI 8/10-40										932			52
KI 8/11-40										962			53
KI 8/12-55										992			62
KI 8/13-55										1140			63
KI 8/14-55										1170			64
KI 8/15-55										1200	67		
KI 8/16-75										1230	300	318	83
KI 8/17-75										1260			84
KI 8/18-75										1290			85
KI 8/19-75										1320			87
KI 8/20-75										1350			88

TYPE	DIMENSIONS												
	Inlet	Out	A	B	C	D	E	ØF	H	H1	G	G1	Weight
KI 12/2-15	DN40	DN40	220	184	190	110	285	13	115	650	176	216	27
KI 12/3-22										680			33
KI 12/4-30										752			38
KI 12/5-30										782	194	231	39
KI 12/6-40										812			47
KI 12/7-55										960			57
KI 12/8-55										990			58
KI 12/9-55										1020	300	318	59
KI 12/10-75										1020			75
KI 12/11-75										1050			76
KI 12/12-75										1103			77
KI 12/13-110										1126			92
KI 12/14-110										1170			93
KI 12/15-110										1200			96
KI 12/16-110										1230			97
KI 12/17-110										1260			98
KI 12/18-110										1290			99

TYPE	DIMENSIONS														
	Inlet	Out	A	B	C	D	E	ØF	H	H1	G	G1	Weight		
KI 16/2-22	DN40	DN40	220	184	190	110	285	13	115	664	175	215	33		
KI 16/3-30										751			195	230	38
KI 16/4-40										795					46
KI 16/5-55										959	300	320	56		
KI 16/6-55										1004			58		
KI 16/7-75										1049			74		
KI 16/8-75										1094			76		
KI 16/9-75										1116			78		
KI 16/10-110										1184			93		
KI 16/11-110										1229			95		
KI 16/12-110										1274	97				
KI 16/13-150										1319	300	400	135		
KI 16/14-150										1364			137		
KI 16/15-150										1409			138		
KI 16/16-150										1454			140		

TYPE	DIMENSIONS														
	Inlet	Out	A	B	C	D	E	ØF	H	H1	G	G1	Weight		
KI 20/2-22	DN40	DN40	220	184	190	110	285	13	115	664	176	216	33		
KI 20/3-40										751			194	231	45
KI 20/4-55										914					54
KI 20/5-55										959	310	318	56		
KI 20/6-75										1004			73		
KI 20/7-75										1049			75		
KI 20/8-110										1094			90		
KI 20/9-110										1139			92		
KI 20/10-110										1184			93		
KI 20/11-110										1229			95		
KI 20/12-150										1380	310	400	133		
KI 20/13-150										1425			135		
KI 20/14-150										1470			137		
KI 20/15-150										1515			139		
KI 20/16-185										1560			152		
KI 20/17-185										1605			153		



## EVS Series

High quality pumps with compact construction and high efficiency with AISI304 grade stainless steel on all water contact surfaces. Features in-line (on the same axis) inlet-outlet connections.

### Fields of Use

- Pressurized water supply in residential and commercial buildings
- Garden irrigation systems
- Agricultural irrigation systems.
- Industrial applications
- Water treatment systems
- Clean water transfer

### Pump Specifications

- Pump Body : AISI 304 Stainless Steel
- Impeller & Diffuser : AISI 304 Stainless Steel
- Pump Shaft : AISI 420 Stainless Steel
- Mechanical Seal : Carbon / Ceramic / EPDM

### Technical Specifications

- Maximum Flow : 110 m<sup>3</sup>/h
- Maximum Pressure : 310 mwc
- Inlet-Outlet Diameter : DN80 & DN100
- Pressure Class : PN32
- Max. Ambient Temperature : 40°C
- Fluid Temperature : 0 - 100°C
- Fluid Property : Clean, solid particle-free, chemically neutral water
- Motor Speed : 2900 rpm
- Network Connection : 3\*380V - 50 Hz
- Motor Power : 4 - 45 kW
- Protection Class : IP55
- Insulation Class : F

## Identification Code

**EVS 32 / 8 / 15**

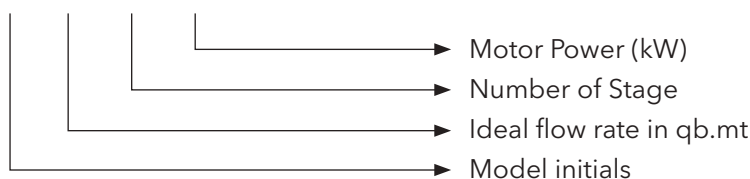

# EVS Series Family Curves

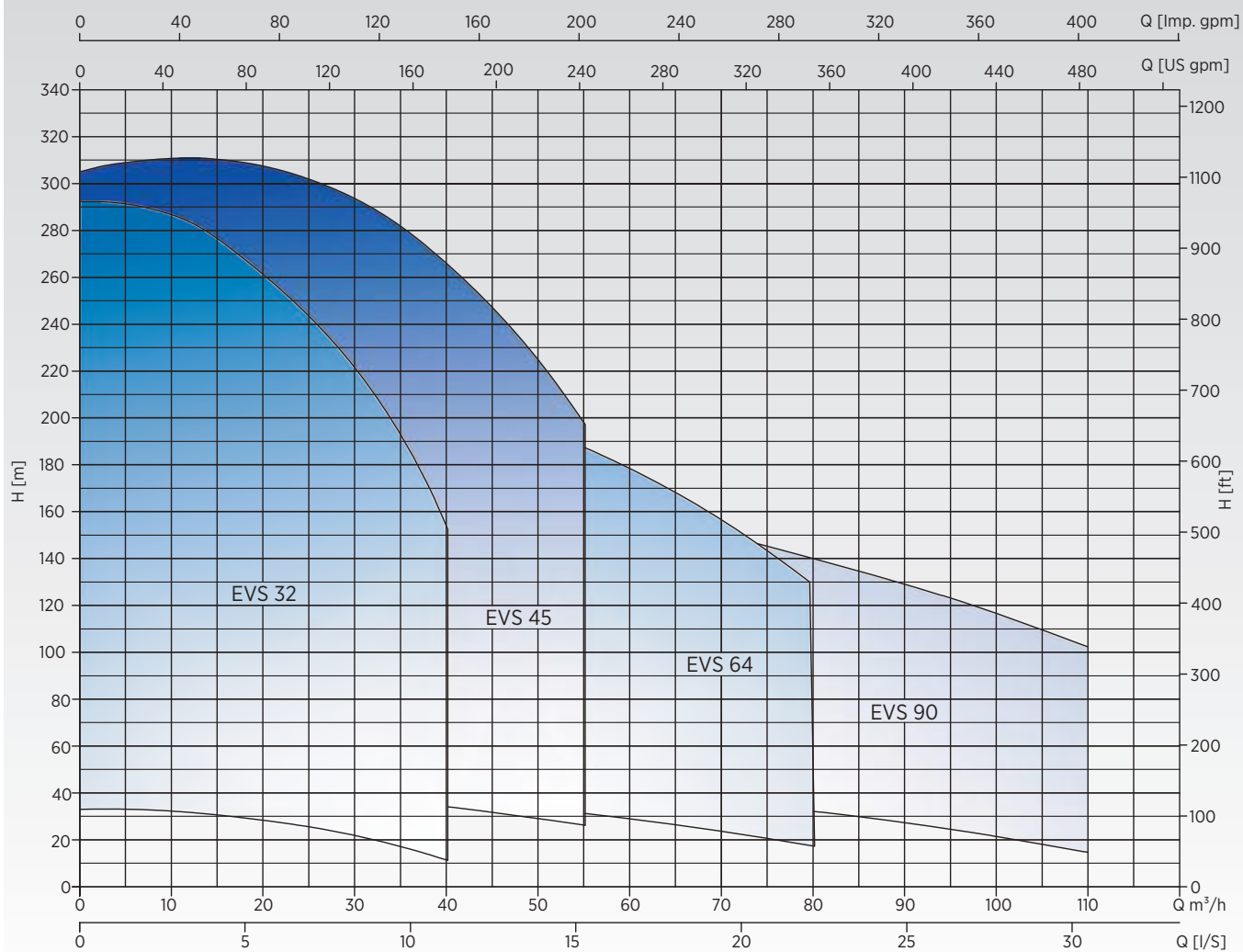





**EVS 32 Series**

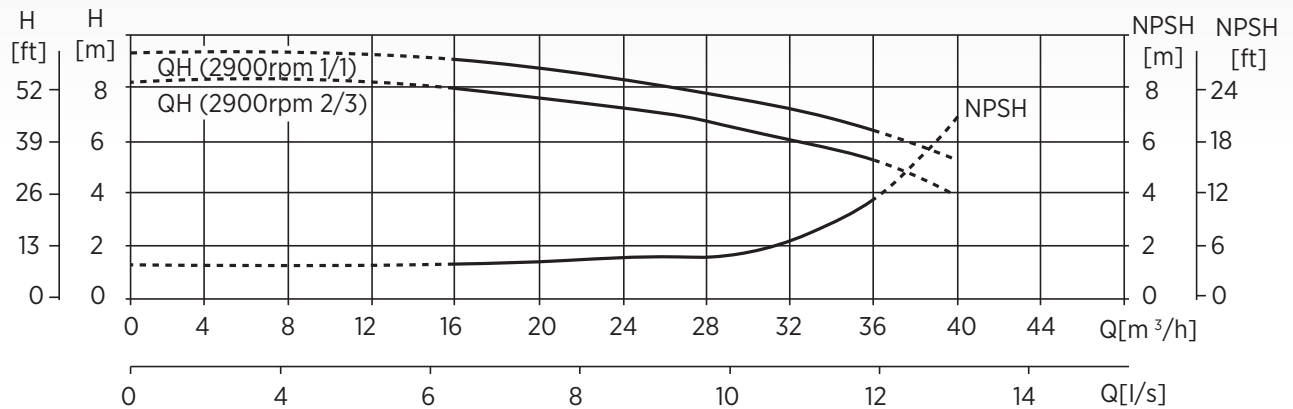
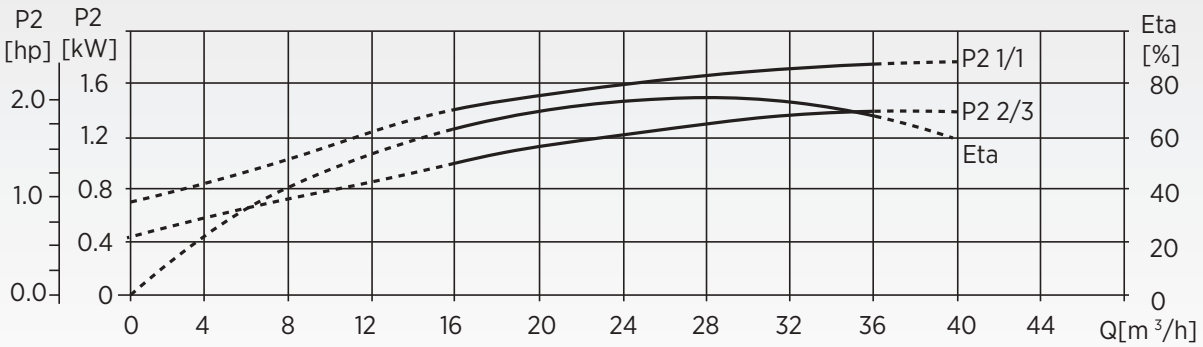
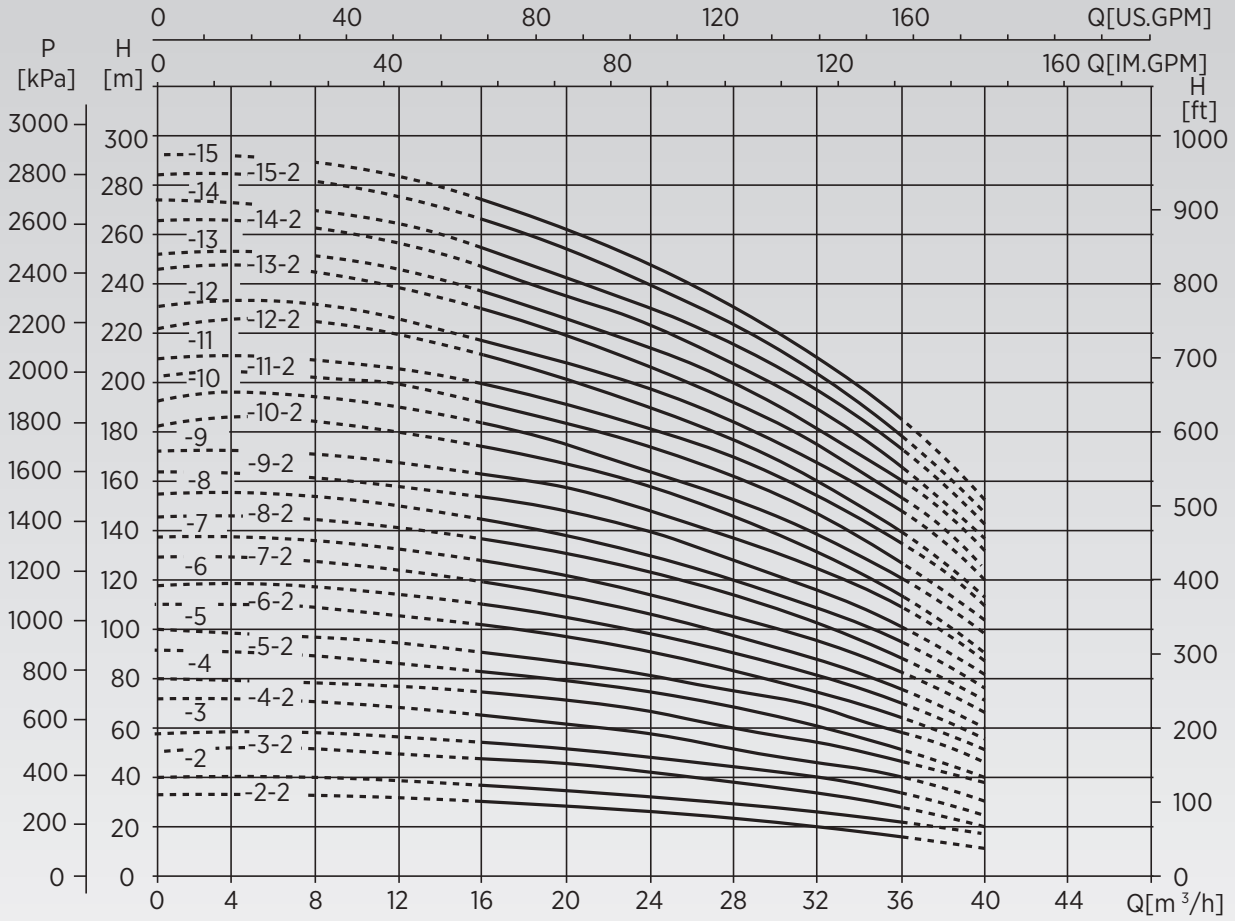

# EVS Series Performance Curves

## EVS 45 Series

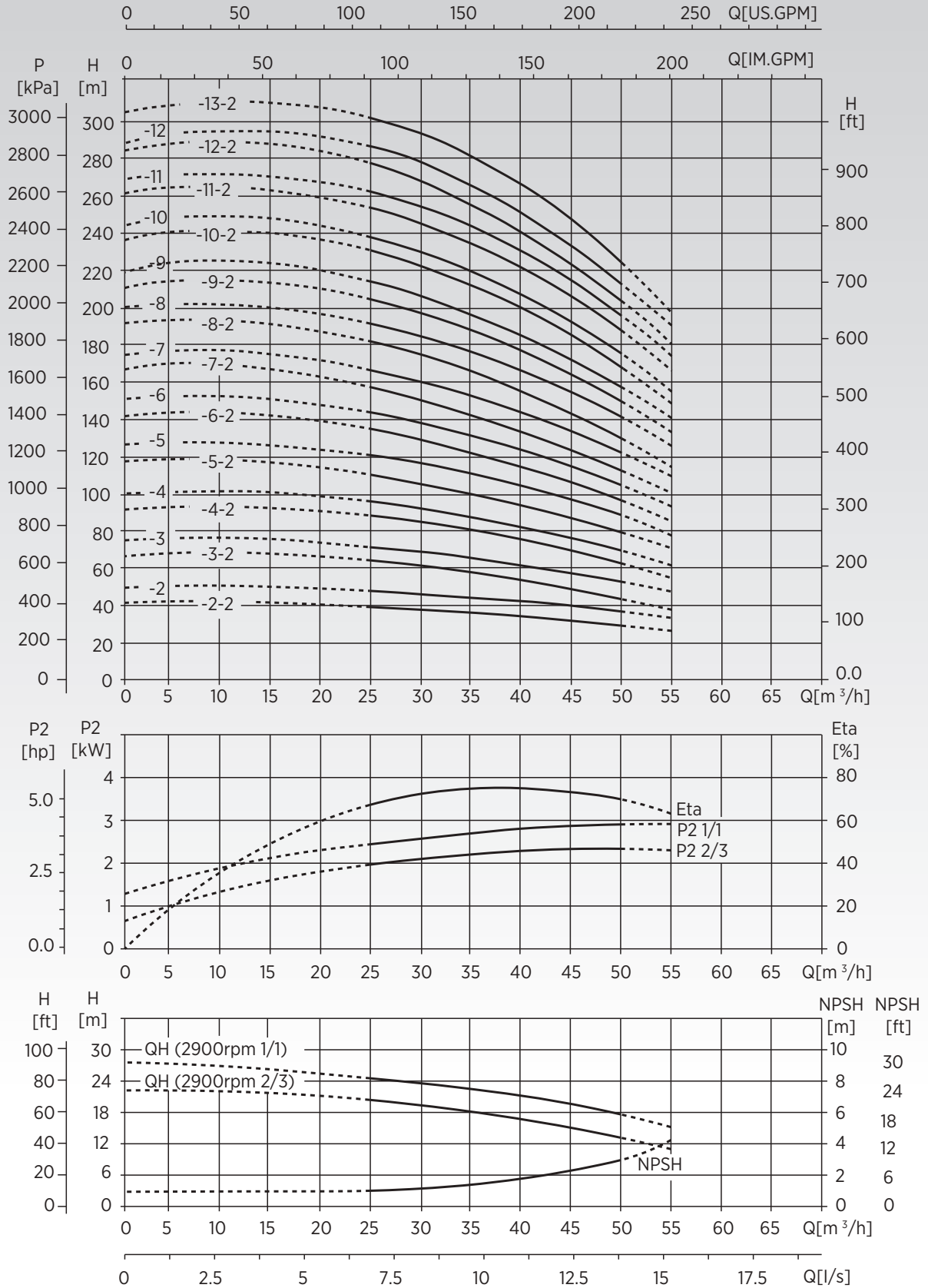



## EVS 64 Series

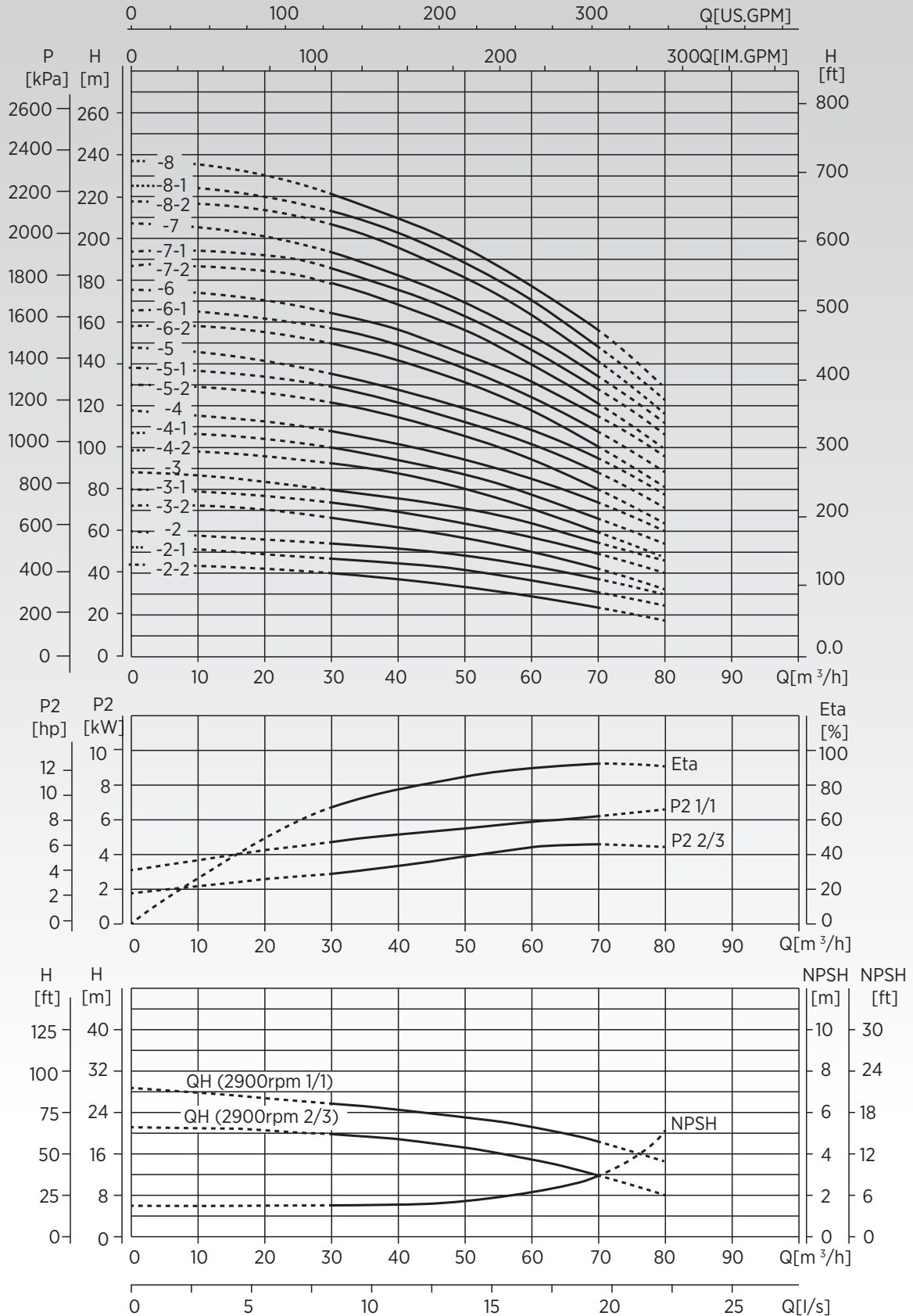

# EVS Series Performance Curves

## EVS 90 Series

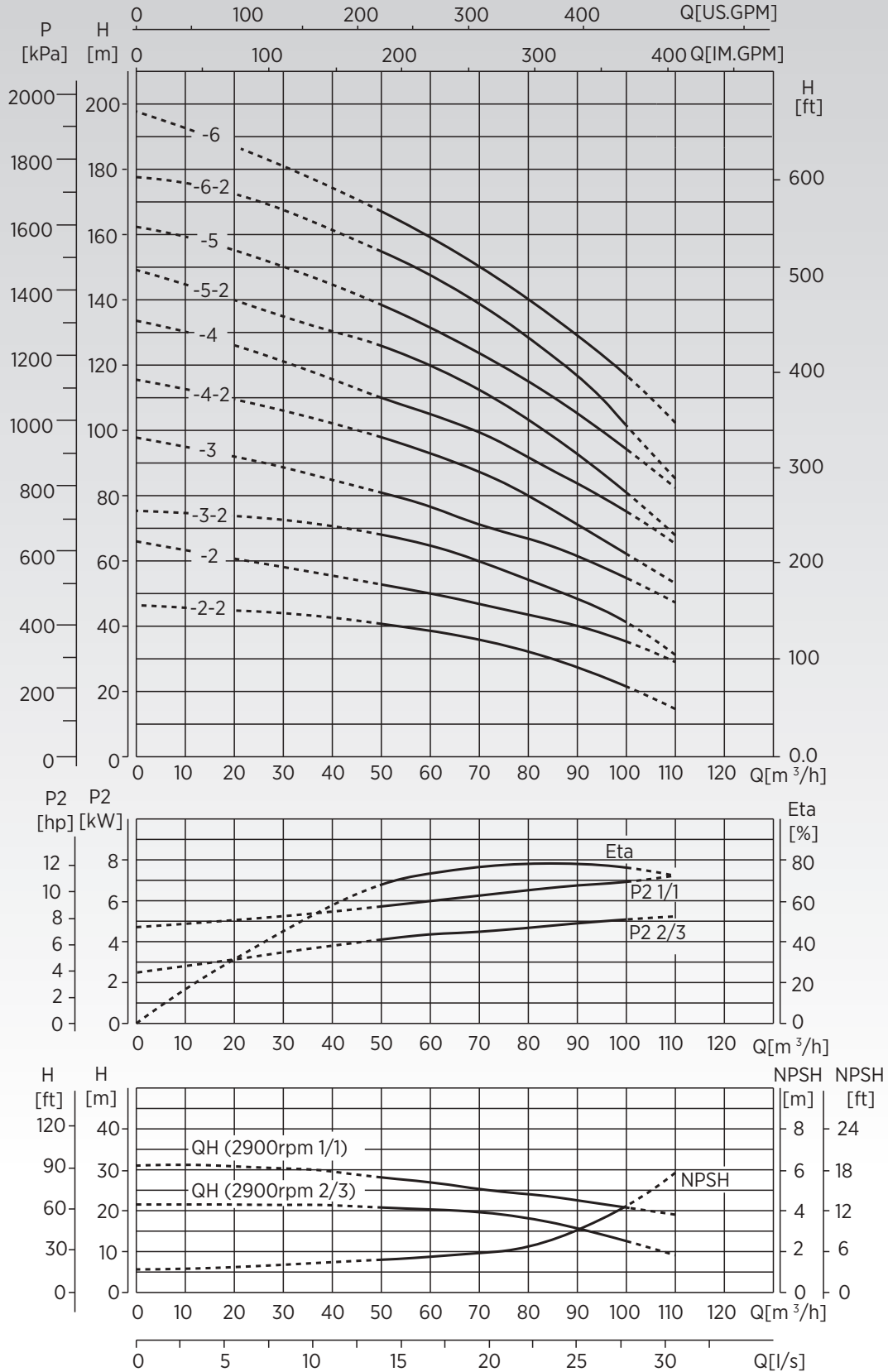

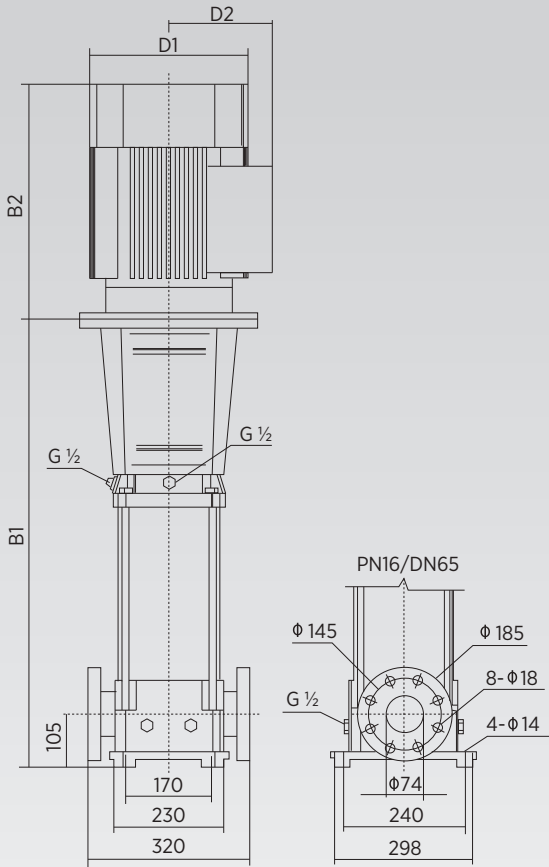

TYPE	DIMENSIONS (mm)					NET WEIGHT (kg)
	B1	B2	B1+B2	D1	D2	
EVS 32-2-2	634	325	959	191	140	74/78
EVS 32-2	634	355	989	212	163	81/85
EVS 32-3-2	724	395	1119	258	163	100/104
EVS 32-3	724	395	1119	258	163	100/104
EVS 32-4-2	794	395	1189	258	163	106/110
EVS 32-4	794	395	1189	258	163	106/110
EVS 32-5-2	894	498	1392	315	251	185/189
EVS 32-5	894	498	1392	315	251	185/189
EVS 32-6-2	964	498	1462	315	251	189/193
EVS 32-6	964	498	1462	315	251	189/193
EVS 32-7-2	1034	498	1532	315	251	203/207
EVS 32-7	1034	498	1532	315	251	203/207
EVS 32-8-2	1104	498	1602	315	251	207/211
EVS 32-8	1104	498	1602	315	251	207/211
EVS 32-9-2	1174	542	1716	315	251	228/232
EVS 32-9	1174	542	1716	315	251	228/232
EVS 32-10-2	1244	542	1786	315	251	232/236
EVS 32-10	1244	542	1786	315	251	232/236
EVS 32-11-2	1314	578	1892	355	267	278/282
EVS 32-11	1314	578	1892	355	267	278/282
EVS 32-12-2	1384	578	1962	355	267	281/286
EVS 32-12	1384	578	1962	355	267	281/286
EVS 32-13-2	1454	669	2123	397	299	361/365
EVS 32-13	1454	669	2123	397	299	361/365
EVS 32-14-2	1524	669	2193	397	299	364/369
EVS 32-14	1524	669	2193	397	299	364/369
EVS 32-15-2	1594	669	2263	397	299	368/373
EVS 32-15	1594	669	2263	397	299	368/373

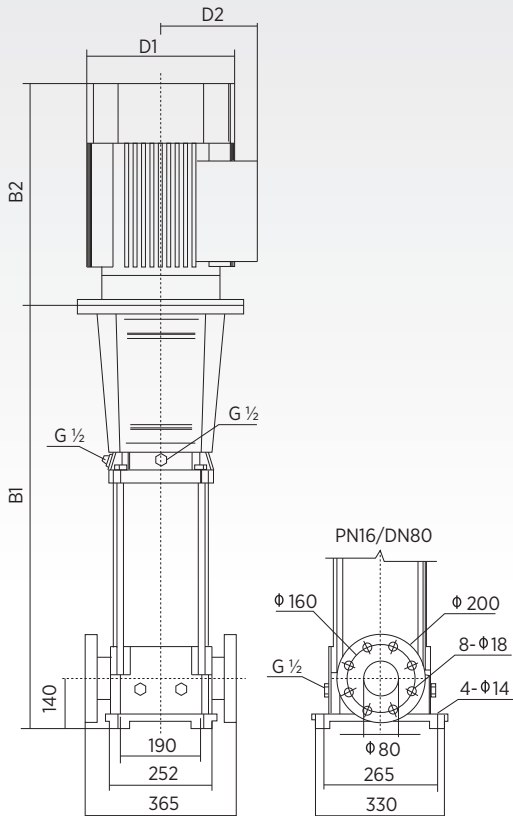

TYPE	DIMENSIONS (mm)					NET WEIGHT (kg)
	B1	B2	B1+B2	D1	D2	
EVS 45-2-2	716	395	1111	258	163	109/117
EVS 45-2	716	395	1111	258	163	113/121
EVS 45-3-2	826	498	1324	315	251	190/197
EVS 45-3	826	498	1324	315	251	190/197
EVS 45-4-2	906	498	1404	315	251	204/211
EVS 45-4	906	498	1404	315	251	204/211
EVS 45-5-2	986	542	1528	315	251	225/233
EVS 45-5	986	542	1528	315	251	225/233
EVS 45-6-2	1066	578	1644	355	267	272/279
EVS 45-6	1066	578	1644	355	267	272/279
EVS 45-7-2	1146	669	1815	397	299	351/359
EVS 45-7	1146	669	1815	397	299	354/361
EVS 45-8-2	1226	669	1895	397	299	351/359
EVS 45-8	1226	669	1895	397	299	354/361
EVS 45-9-2	1306	669	1975	397	299	380/388
EVS 45-9	1386	669	2055	397	299	358/366
EVS 45-10-2	1386	669	2055	397	299	385/392
EVS 45-10	1466	669	2135	446	299	385/392
EVS 45-11-2	1466	709	2175	446	322	450/457
EVS 45-11	1546	709	2255	446	322	450/457
EVS 45-12-2	1546	709	2255	446	322	454/462
EVS 45-12	1626	709	2335	446	322	454/462
EVS 45-13-2	1626	709	2335	446	322	458/465

# EVS Series Dimensions and Weights

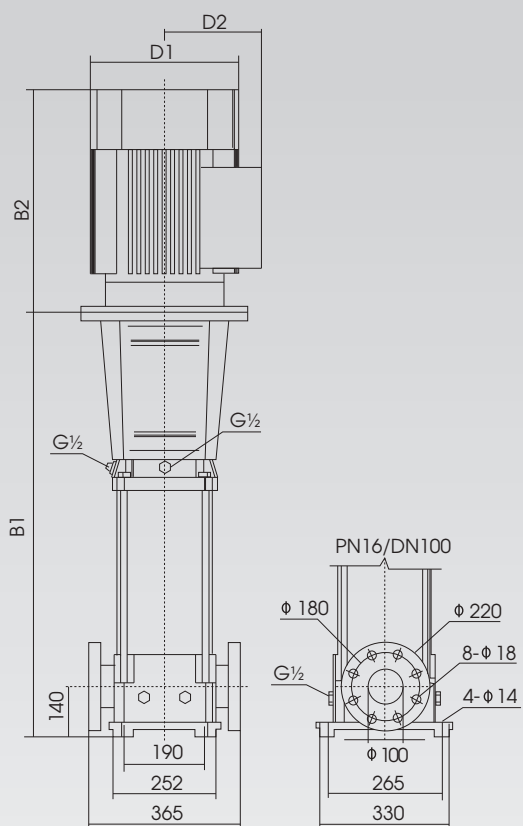

TYPE	DIMENSIONS (mm)					NET WEIGHT (kg)
	B1	B2	B1+B2	D1	D2	
EVS 64-2-2	685	390	1075	259	203	133/141
EVS 64-2-1	715	498	1213	314	251	197/204
EVS 64-2	715	498	1213	314	251	197/204
EVS 64-3-2	825	498	1323	314	251	197/204
EVS 64-3-1	825	498	1323	314	251	210/218
EVS 64-3	825	542	1367	314	251	228/235
EVS 64-4-2	905	542	1447	314	251	231/238
EVS 64-4-1	905	578	1483	355	267	274/282
EVS 64-4	905	578	1483	355	267	274/282
EVS 64-5-2	985	669	1653	397	299	354/361
EVS 64-5-1	985	669	1653	397	299	354/361
EVS 64-5	985	669	1653	397	299	354/361
EVS 64-6-2	1065	669	1734	397	299	358/366
EVS 64-6-1	1065	669	1734	397	299	380/388
EVS 64-6	1065	669	1734	397	299	380/388
EVS 64-7-2	1145	669	1814	397	299	386/394
EVS 64-7-1	1145	669	1814	397	299	386/394
EVS 64-7	1145	709	1864	446	322	445/453
EVS 64-8-2	1225	709	1934	446	322	450/457
EVS 64-8-1	1225	709	1934	446	322	450/457
EVS 64-8	1225	709	1934	446	322	450/457

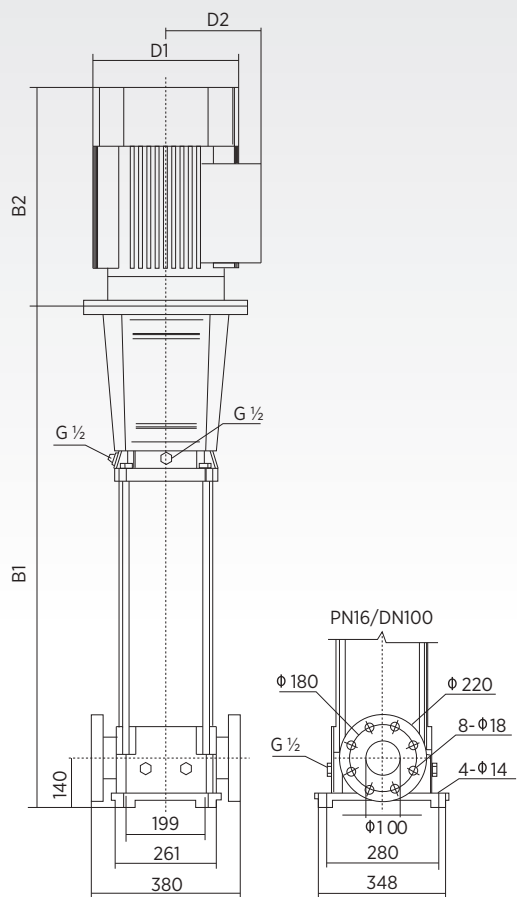

TYPE	DIMENSIONS (mm)					NET WEIGHT (kg)
	B1	B2	B1+B2	D1	D2	
EVS 90-2-2	771	498	1269	314	251	196/204
EVS 90-2	771	498	1269	314	251	207/214
EVS 90-3-2	863	542	1405	314	251	227/235
EVS 90-3	863	578	1441	355	267	269/277
EVS 90-4,2	955	669	1624	397	299	341/349
EVS 90-4	955	669	1624	397	299	341/349
EVS 90-5-2	1047	669	1716	397	299	376/383
EVS 90-5	1047	669	1716	397	299	376/383
EVS 90-6-2	1139	709	1848	446	322	439/447
EVS 90-6	1139	709	1848	446	322	439/447





Dudullu Organize Sanayi Bölgesi 2. Cadde No: 14  
34775 Ümraniye İstanbul / Turkey  
Tel : +90 216 561 47 74 (Pbx) • Fax : +90 216 561 47 50  
[www.etna.com.tr/en](http://www.etna.com.tr/en) • [info@etna.com.tr](mailto:info@etna.com.tr)



**ETNA®**